

**amaran**<sup>®</sup>

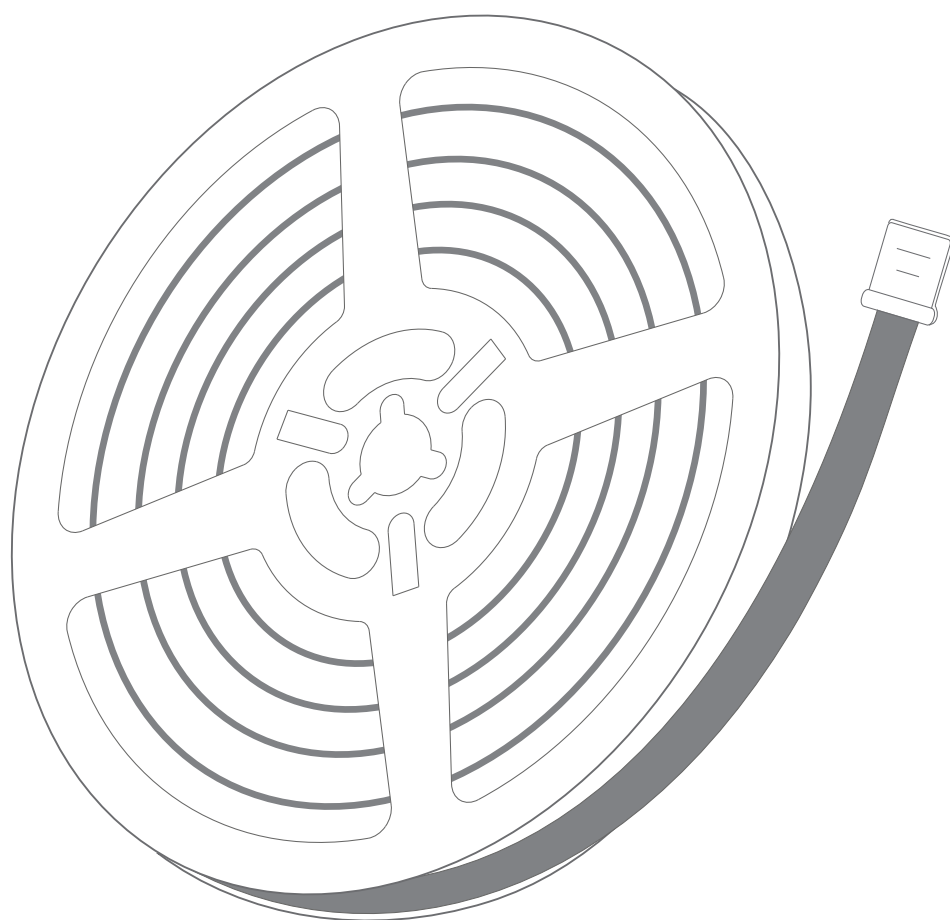

**amaran SM5c**

**Product Manual**

English

# Introduction

Thank you for purchasing the "amaran" SM5c LED strip light.

The amaran SM5c is a Bluetooth and Wifi-connected RGB pixel light strip. Featuring smart-speaker compatibility, Sidus Link app control, and 100 lighting zones across 5 meters for smooth lighting effects, the SM5c easily creates a colorful and creative atmosphere for video production and daily life.

## IMPORTANT SAFETY INSTRUCTIONS

When using this unit, basic safety precautions should always be followed, including the following:

- 1 . Read and understand all instructions before using.
- 2 . Close supervision is necessary when any fixture is used by or near children. Do not leave the fixture unattended while in use.
- 3 . Care must be taken as burns can occur from touching hot surfaces.
- 4 . Do not operate the fixture if a cord is damaged, or if the fixture has been dropped or damaged, until it has been examined by qualified service personnel.
- 5 . Position any power cables such that they will not be tripped over, pulled, or put into contact with hot surfaces.
- 6 . If an extension cord is necessary, a cord with an amperage rating at least equal to that of the fixture should be used. Cords rated for less amperage than the fixture may overheat.
- 7 . Always unplug the lighting fixture from the electrical outlet before cleaning and servicing, or when not in use. Never yank the cord to remove the plug from the outlet.
- 8 . Let the lighting fixture cool completely before storing. Unplug the power cable from lighting fixture before storing and store the cable at assigned space.
- 9 . To reduce the risk of electric shock, do not immerse this fixture in water or any other liquids.
- 10 . To reduce the risk of fire or electric shock, do not disassemble this fixture. Contact [cs@aputure.com](mailto:cs@aputure.com) or take the lighting fixture to qualified service personnel when service or repair is required. Incorrect reassembly may cause electric shock when the lighting fixture is in use.
11. The use of any accessory attachment not recommended by the manufacturer may increase the risk of fire, electric shock, or injury to any persons operating the fixture.
12. Please do not block the ventilation or do not look at the LED light source directly when it is powered on. Please do not touch the LED light source in any condition.
13. Please do not place the LED lighting fixture near any flammable object.
14. Only use a dry microfiber cloth to clean the product.
15. Please do not use the light fixture in wet conditions on account of electric shock may be caused.
16. Please have the product checked by an authorized service personnel agent if the product has a problem. Any malfunctions caused by unauthorized disassembly are not covered by the warranty. The user may pay for maintenance.
17. We recommend only using the original Aputure or amaran cable accessories. Please note that any malfunctions caused by using unauthorized accessories are not covered by the warranty. The user may pay for maintenance.
18. This product is certified by RoHS, CE, KC, PSE, and FCC. Please operate the product in full compliance with relevant country's standards. Any malfunctions caused by incorrect use are not covered by warranty. The user may pay for maintenance.
19. The instructions and information in this manual are based on thorough, controlled company testing procedures. Further notice will not be given if the design or specifications change.

# SAVE THESE INSTRUCTIONS

## FCC Compliance Statement

This device complies with Part 15 of the FCC Rules. Operation is subject to the following two conditions:

- (1) This device may not cause harmful interference.
- (2) This device must accept any interference received, including interference that may cause undesired operation.

### WARNING

Changes or modifications not expressly approved by the party responsible for compliance could void the user's authority to operate the equipment.

### NOTICE

This equipment has been tested and found to comply with the limits for a Class B digital device, pursuant to Part 15 of the FCC Rules. These limits are designed to provide reasonable protection against harmful interference in a residential installation. This equipment generates, uses, and can radiate radio frequency energy and, if not installed and used in accordance with the instructions, may cause harmful interference to radio communications. However, there is no guarantee that interference will not occur in a particular installation.

If this equipment does cause harmful interference to radio or television reception, which can be determined by turning the equipment off and on, the user is encouraged to try reorient or relocate the receiving antenna.

1. Increase the separation between the equipment and receiver.
2. Connect the equipment to an outlet on a different circuit than the receiver is connected to.
3. Consult the dealer or an experienced radio/TV technician for help.

### RF Warning Statement:

This device has been evaluated to meet general RF exposure requirements.

## Components List

Please make sure all accessories listed below are included before using. If not, please contact your sellers immediately.

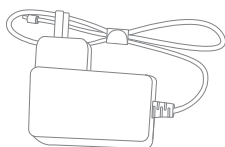

Power adapter (1 pc)

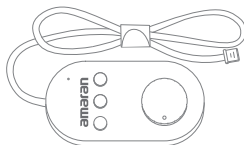

Controller (1 pc)

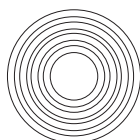

Double-sided tape (1 pc)



Alcohol  
Prep Pad

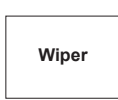

Wiper

Cleaning kit (1 set)

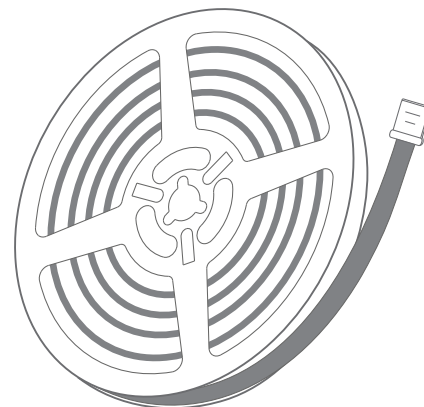

Strip light (1 pc)

*\*The illustrations in the manual are only diagrams for reference. Due to the continuous development of new versions of the product, if there are any differences between the product and the user manual diagrams, please refer to the product itself.*

# Product Details

## 1. Strip light

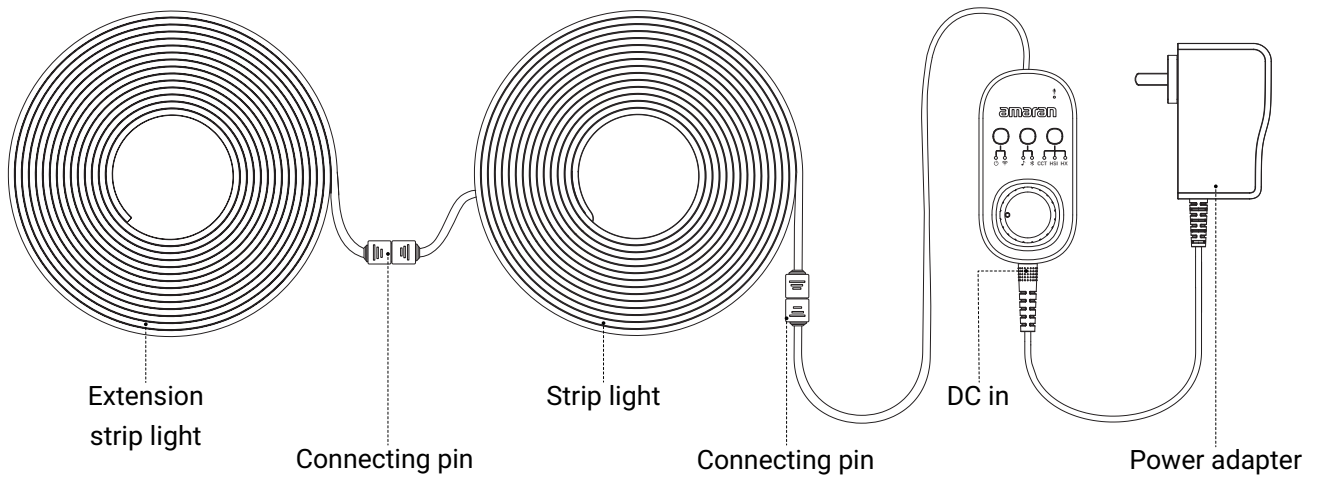

*\*The amaran SM5c extension is sold separately.*

## 2. Control box

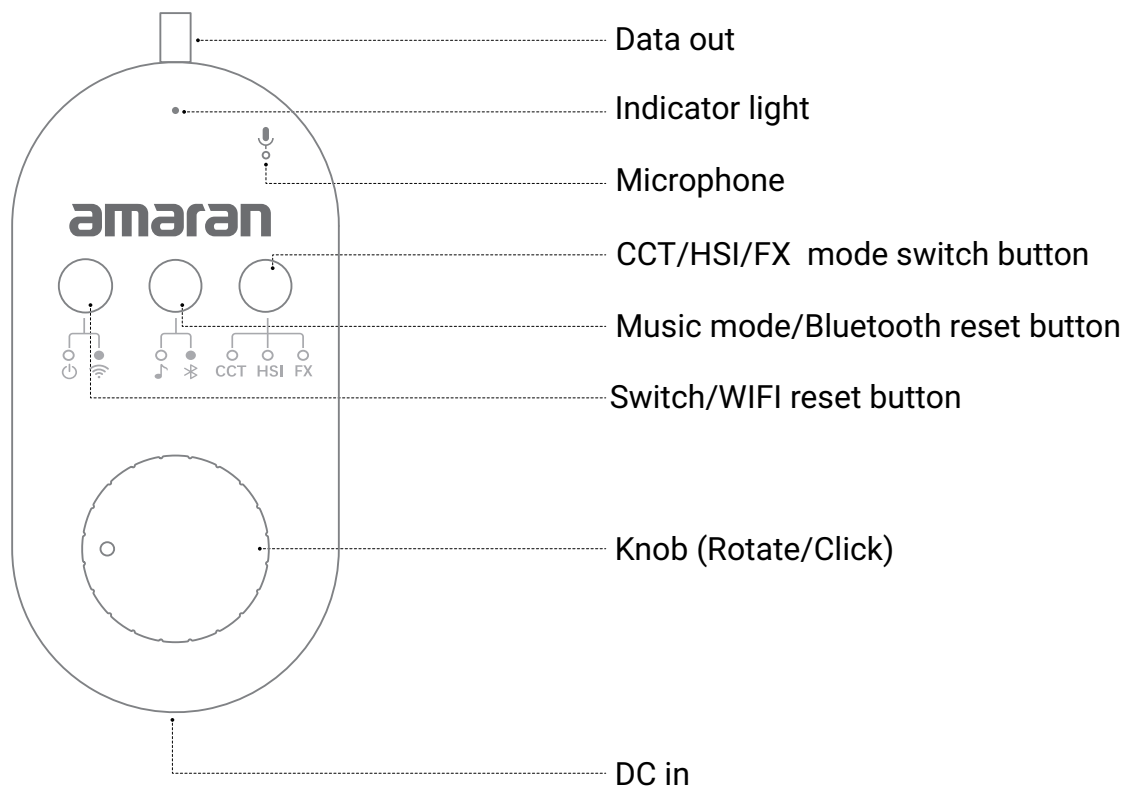

# Setting Up the Light

## Installing strip light

1. Choose a dry, clean and smooth surface to install the strip light.

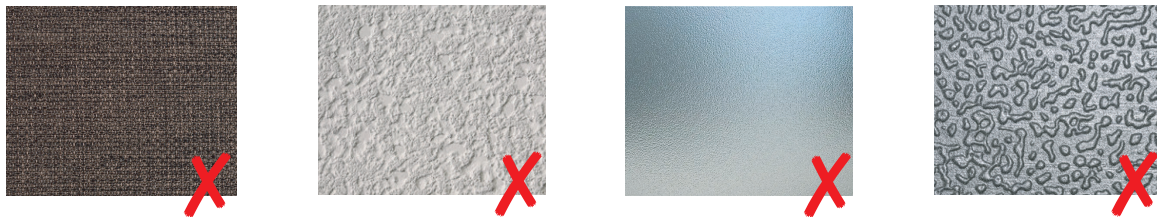

*\*Do not install strip light on surfaces such as fabric, dusty walls, rough plastic, and frosted glass.*

2. Clean the mounting surface with the included cleaning kit.

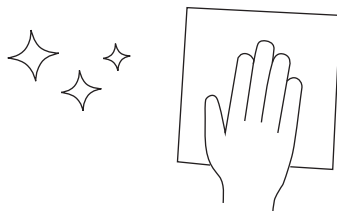

3. When the ambient temperature is lower than 10°C/50°F, please use a hair dryer to heat it before installation to achieve the best adhesive effect.

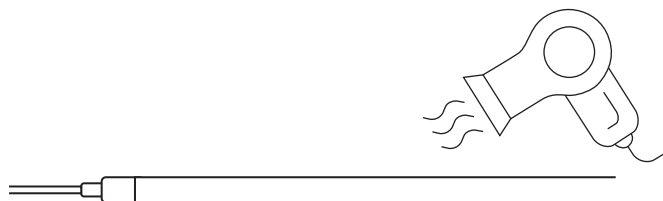

4. After confirming the installation position, remove the dustproof paper tape from the double-sided tape on the back of the strip light, and mount the strip light to your chosen surface.

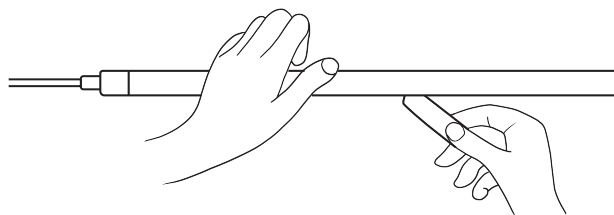

5. After the strip light is installed, use the included double-sided tape to reinforce any corners or areas where the adhesive is not strong.

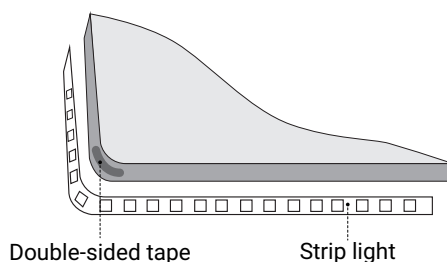

6. After arranging the control box and wires to the desired position, fix them with double-sided tape.

# Powering up the Light

## 1. Connect the control box and the strip light.

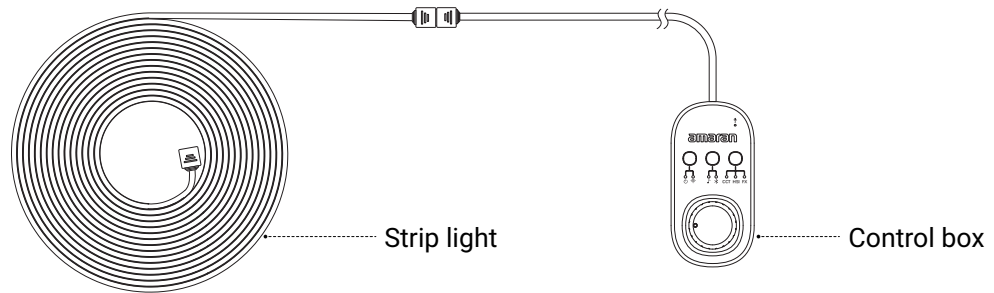

## 2. Connect the light strip and the extension light strip.

Light strip and extension light strip are connected via connector

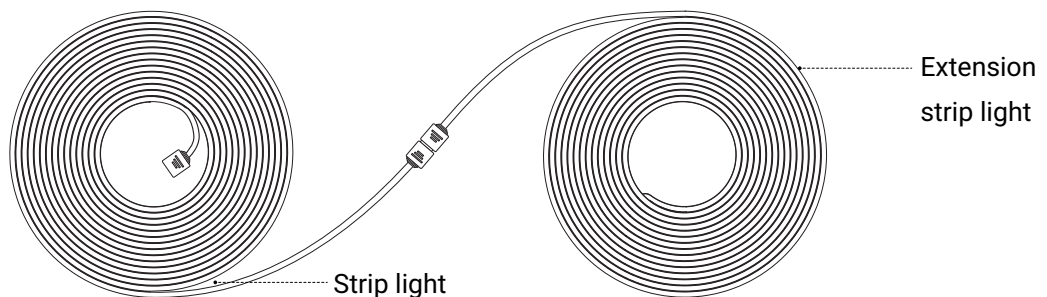

The triangle mark on the connector must be on the same side, do not insert it backwards.

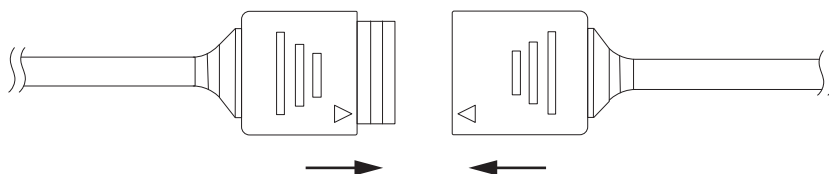

*\*One controller can connect up to a 5m strip light + ONE 5m extension strip light, for a total of 10m length.*

*\*Connect the initial strip light to the controller first, and then add the extension strip light.*

*\*The extension strip light needs to be purchased separately.*

*\*Connecting the extension strip light will reduce the power output of each strip by half to match the power output of the power adapter.*

## 3. Connect the control box and the power adapter.

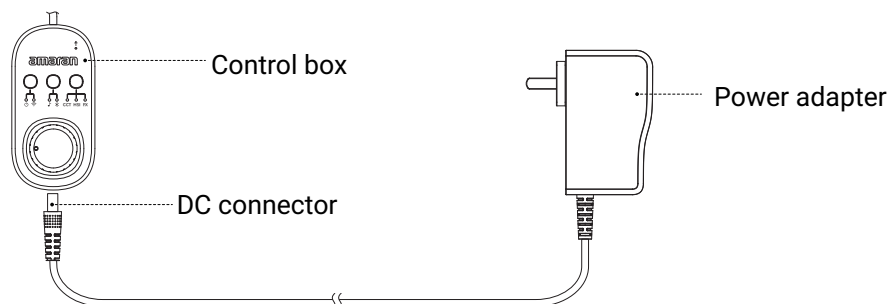

## 4. Plug the Power Adapter into an AC power socket.

## WARNING

Trimming of the light strip(s) should be avoided as it will result in a delayed boot-up process and certain Pixel FX will be incomplete, including Snake, Timing, Pinball, Clock, and Fuse.

# Operating the Light

## 1. Manual Control

### ON-OFF / Wi-Fi reset button:

Short press the button to switch the strip light on and off, press and hold the button for three seconds to reset Wi-Fi connection. After the Wi-Fi reset is successful, the indicator light will flash quickly.

### Music Mode/Bluetooth reset button:

Short press the button to activate the Music Sync or Music Mode, press and hold the button for three seconds to reset the Bluetooth connection. After the Bluetooth reset is successful, the indicator light will begin flashing quickly.

### CCT/HSI/FX Mode switch button:

Press this button to toggle between the three different lighting modes.

### Knob:

In CCT mode, rotate the knob to adjust the brightness/color temperature, click the knob to toggle between brightness & color temperature.

In HSI mode, rotate the knob to adjust the brightness/hue, click the knob to toggle between brightness & hue.

In FX mode, rotate the knob to adjust the brightness/effects, click the knob to toggle between brightness & lighting effects.

## 2. Connect to Sidus Link APP control

2.1. Download the "Sidus Link" APP with a smartphone or tablet and create an account if needed.

Then turn on the Bluetooth of your phone or tablet.

2.2. Short press the "Power On/WiFi Reset" button to power on the light, then press and hold the "Music/Bluetooth Reset" button for 3s until the indicator light flashes quickly to indicate a successful Bluetooth Reset

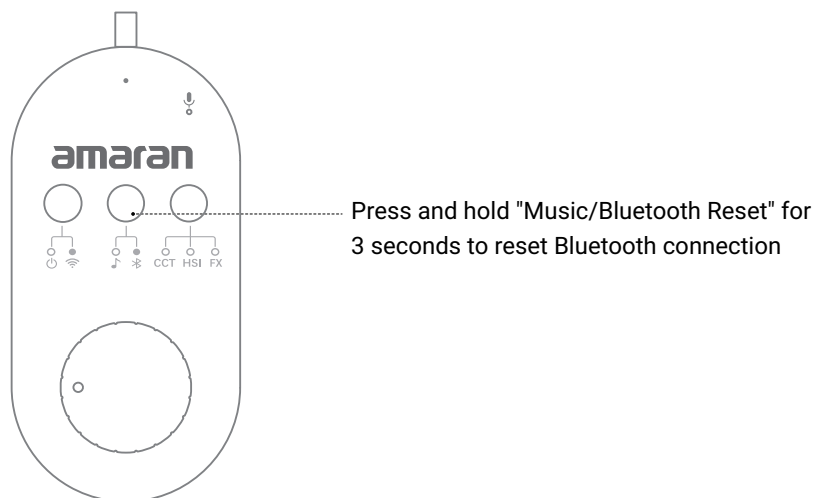

2.3. Open the Sidus Link APP to add the light in a scene (create a new scene if needed).

After the connection is successful, the strip light can be controlled.

### 3. Connecting Smart Speaker Control

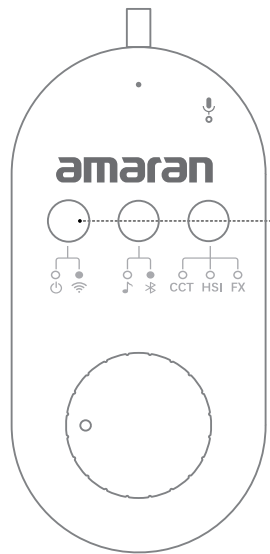

Press and hold "Power On/WiFi Reset" button for 3 seconds to reset the WiFi Connection.



3.2 Connect your phone or tablet to a stable Wi-Fi wireless network. Download the "Tuya Smart" APP with a smartphone or tablet and register an account.

3.3 Open the "Tuya Smart" APP, and follow the instructions to add the SM5c strip light. After successfully connecting to the SM5c, you can control the strip light through the "Tuya Smart" APP.

### 4. Binding "Tuya Smart" Account and Smart Speaker Account

The SM5c supports voice control through smart speakers using "Amazon Alexa" and "Google Assistant." Pair smart speakers with strip light using the following instructions:

#### 4.1 Link an "Amazon Alexa" account and "Tuya"

4.1.1. In the Amazon Alexa APP, tap the  in the bottom right corner of the Home page, and select the  Skills & Games tab.

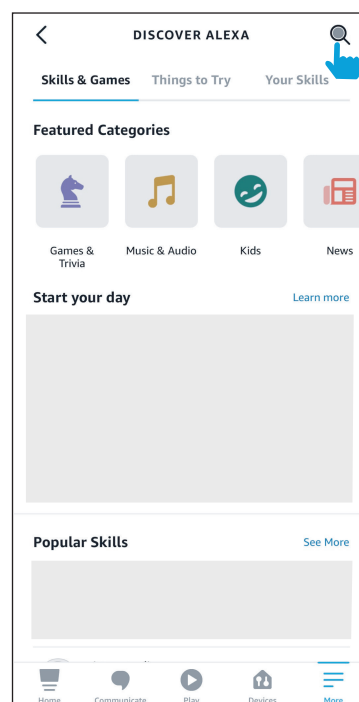
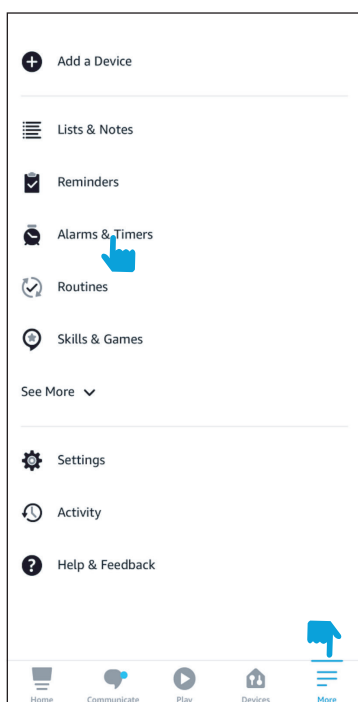



4.1.2. Search for "Tuya Smart" in the search box, and then tap

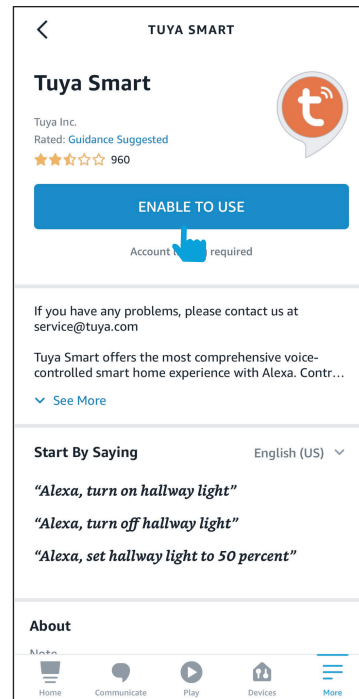
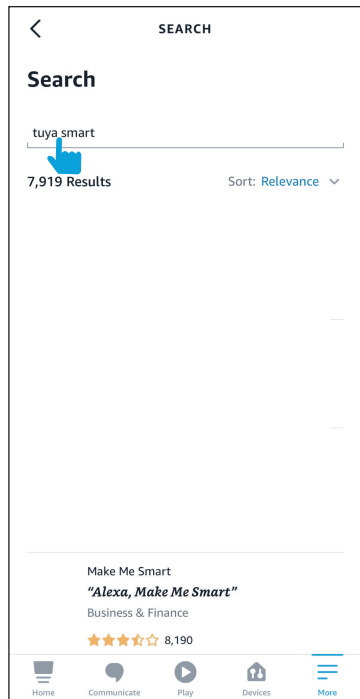

4.1.3. Select the country your account belongs to and enter the account and password of your "Tuya Smart" account, and complete the linking process.

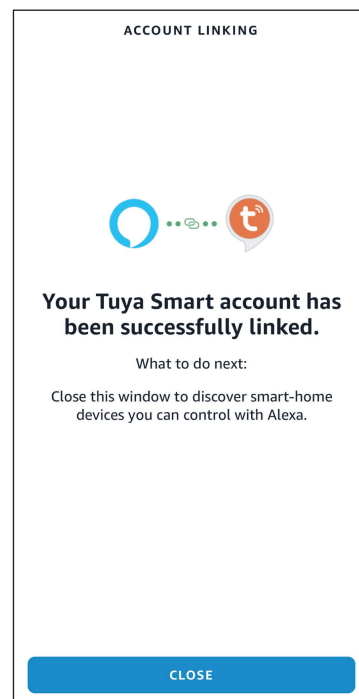
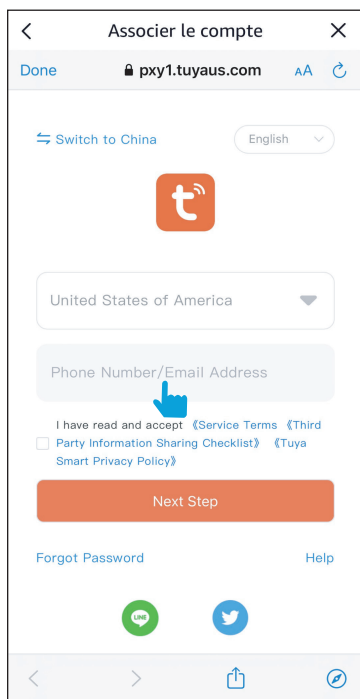

## 4.2 Link a "Google Assistant" account and "Tuya Smart" account

4.2.1. Open the "Google Home" APP, tap the + button in the upper left corner of the home page. Select **Set up device**, and select **Works with Google** under the list.

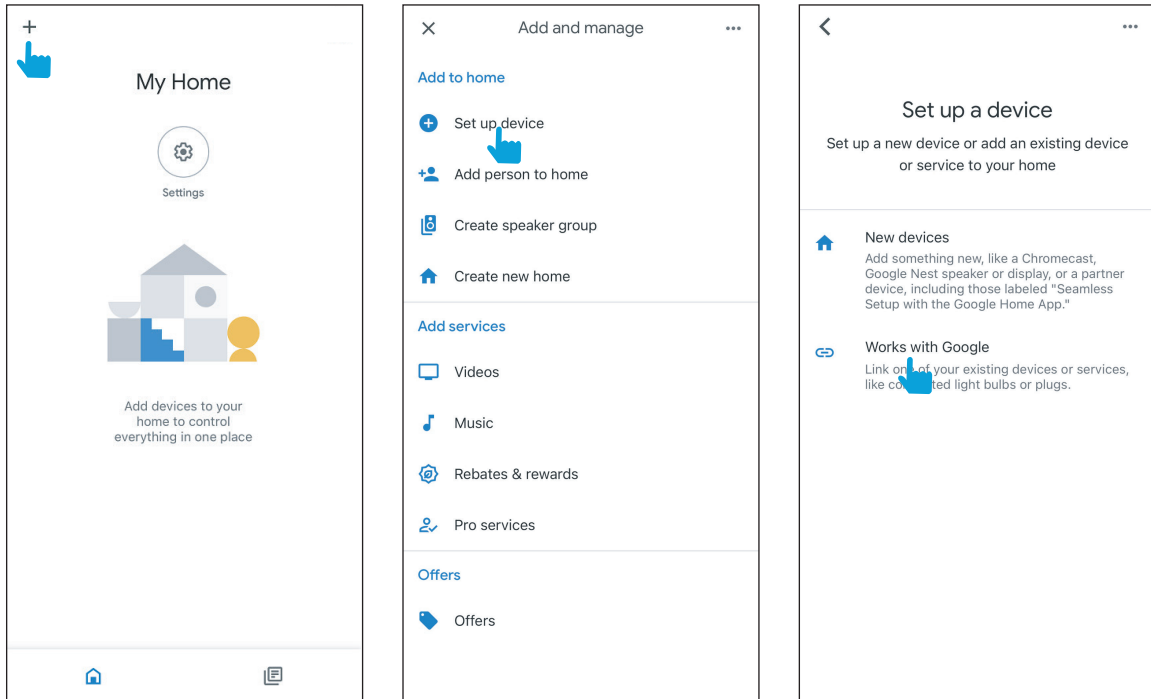

4.2.2. Search for "Tuya Smart" in the list and open it, enter your "Tuya Smart" App account and password, and tap **Next Step** to complete the linking process.

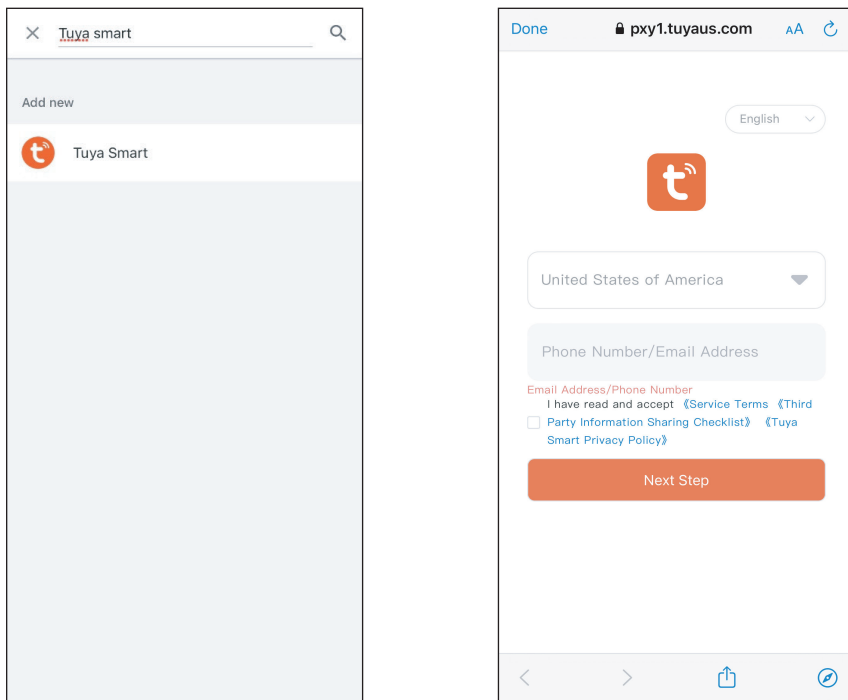

*\*To use smart voice control with the SM5c, customers must connect the fixture to a stable Wi-Fi network and a compatible smart speaker/smart assistant. Smart speakers must be purchased separately by the customer.*

*\*If there are any updates to any of the APPs mentioned above, these instructions may differ from the actual operation of the APP. Please follow the operation guidelines in each APP.*

## 5. Precautions

- 1) Do not use/turn on the strip light in the spool for long periods of time to avoid overheating and damage to the strip light.
- 2) The minimum bending diameter of the strip light is 5cm. Do not wrap the strip light around objects with a diameter of less than 5cm or fold the strip light in half.
- 3) We recommended to use transparent double-sided adhesive tape to reinforce the corners where the strip light is installed to avoid the light falling off.
- 4) The controller can only support up to 10 meters of strip lights (including the strip light and the extension). Do not attempt to connect additional strip lights to this controller.
- 5) This strip light is not waterproof, please do not immerse the strip light in liquid.
- 6) For optimal lighting effects in Music Mode, place the audio source 30cm (1ft) from the control box.
- 7) Trimming of the light strip(s) should be avoided as it will result in a delayed boot-up process and certain Pixel FX will be incomplete, including Snake, Timing, Pinball, Clock, and Fuse.

## Using the Sidus Link APP

You can download the Sidus Link app from the iOS App Store or Google Play Store for enhancing the functionality of the light. Please visit [sidus.link/app/help](https://sidus.link/app/help) for more details regarding how to use the app to control your Aputure lights.



Get Sidus Link® App



[Sidus.link/app/help](https://sidus.link/app/help)

## Specification

<b>Power Input</b>	20W (Max)
<b>Operating Current</b>	1.7A (Max)
<b>Operating Voltage</b>	12VDC
<b>Strip Light Length</b>	5m
<b>Extension Strip Light Length (Purchased Separately)</b>	5m
<b>Operating Temperature</b>	-10°C - +40°C
<b>Control Methods</b>	Manual, Sidus Link App, Smart Home/Voice Control (Tuya, Google Assistant, Amazon Alexa)
<b>Cooling Method</b>	Passive Cooling

# Trademarks

- Amazon Alexa is a trademark registered by Amazon Technologies, Inc. in China and other countries.
- Google Assistant is a trademark registered by Google LLC in China and other countries.
- Tuya is a trademark registered by Tuya Global Inc. in China and other countries.