

amaran[®]

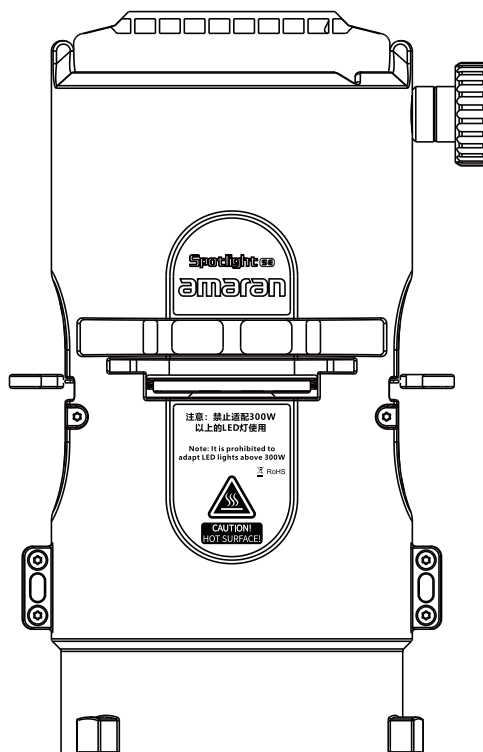

Spotlight SE

Product Manual

English

Introduction

Thank you for purchasing the amaran Spotlight SE.

The Spotlight SE is a Bowens Mount projection lens modifier designed to bring an advanced degree of control to Bowens Mount point-source fixtures up to 300W output including the amaran 150c, 300c, and Aputure LS300d II and LS300x. It transforms your fixtures into a powerful spotlight that can extend the reach of your illumination and produces an even, shapeable output.

Available in 19° and 36° lens options, the Spotlight SE and its interchangeable lenses provide a versatile set of precision light projection tools. For further light shaping capabilities, the optional Spotlight SE Iris can quickly hone the shape and size of the illumination circle. The Spotlight SE also includes an M-Sized Gobo Holder along with a set of 15 M-Sized Gobos which allows you to project unique shapes in your scene.

Safety Instructions

To ensure safe use of the Spotlight SE, always follow basic safety precautions, including:

1. Read and understand all instructions before use.
2. Allow accessories to cool completely before storing them in the case. Remove the Spotlight SE from the lighting fixture and let it cool to room temperature before placing it in the designated position in the safety case. Placing it directly into the case while hot can weaken the shock-absorbing material inside.
3. Before installing the fixture, check if the accessory holder is locked and if any safety cables for the accessory are properly connected.
4. Installing accessories will increase the weight at the front of the fixture. Take care to prevent accidental movement of the fixture when adjusting its tilt angle.
5. Using non-manufacturer recommended accessories may cause melting, fire, or personal injury.
6. Do not block the heat dissipation vents while the product is in operation, and do not look directly into the light beam. Do not touch the lens under any circumstances.
7. Do not place the product near flammable or volatile solvents to avoid damage.
8. The product contains a glass lens. Handle it with care to avoid lens damage.
9. If the lens shows severe scratches or is broken, do not use the accessory. It must be replaced when damaged.
10. When cleaning the lens, use a soft cloth with a mild cleaning agent to remove dirt. Do not use strong cleaning agents.
11. Contact authorized repair personnel for any necessary repairs. The device contains precision lens structures. Unauthorized disassembly will void the warranty, but users can opt for paid repairs.
12. When suspending the product overhead, ensure additional safety measures, such as using a certified safety chain capable of supporting the product's weight.

13. Prolonged use of this accessory may result in high surface temperatures. Take precautions to avoid burns and use heat-resistant gloves when handling. Close supervision is necessary when any fixture is used by or near children.
14. This product is RoHS certified. Please refer to relevant national standards for use and operation. Damage to the machine due to improper use or operation is not covered by the warranty, but users can opt for paid repairs.
15. This user guide is based on strict testing conducted by our company. Design and specifications are subject to change without prior notice.

WARNING

Changes or modifications not expressly approved by the party responsible for compliance could void the user's authority to operate the equipment.

Components List

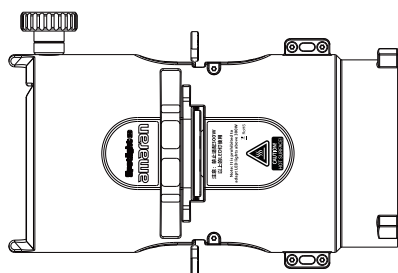

Spotlight SE x1

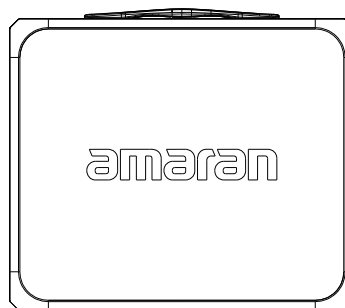

EPP Foam Carrying Case x1

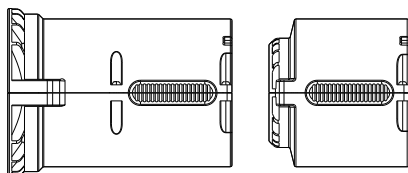

19° lens or 36° lens x1

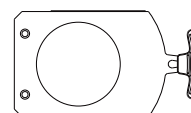

M Size Gobo Holder x1

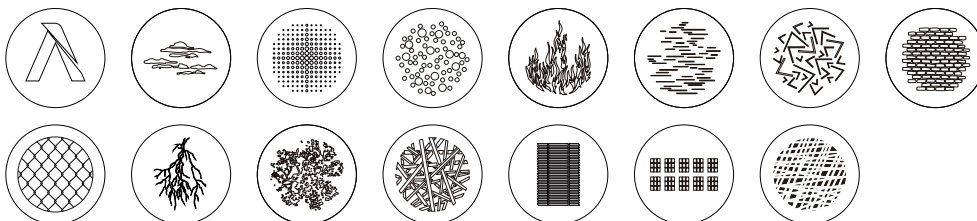

M Size Gobos x15

Note: The illustrations in the manual are only diagrams for reference. Due to the continuous development of new versions of the product, if there are any differences between the product and the user manual diagrams, please refer to the product itself.

Product Overview

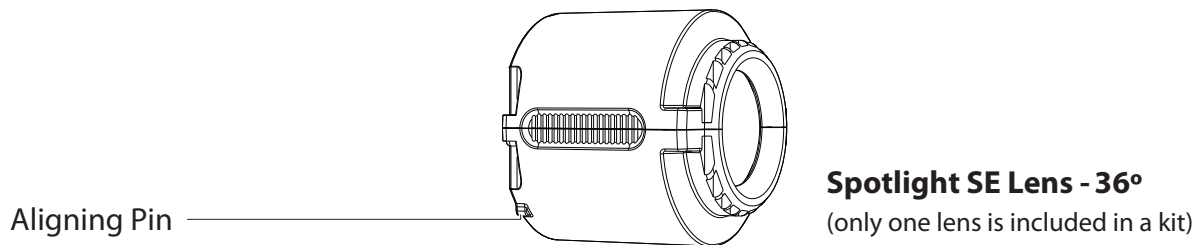
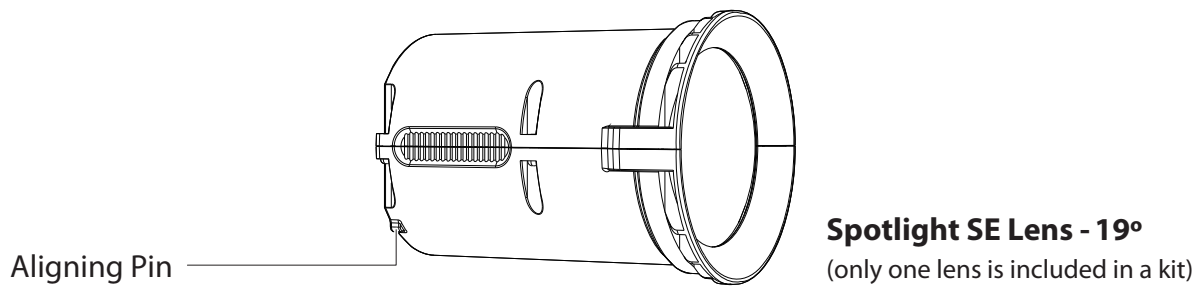
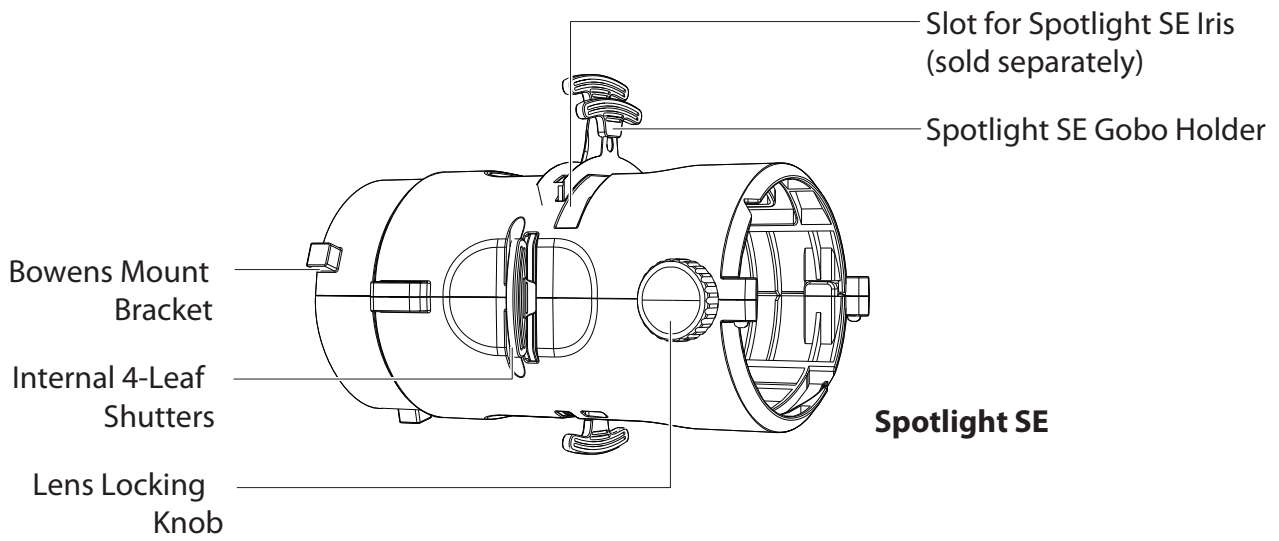

Installation Instructions

Installing and Removing Spotlight SE Lenses

Installing:

1. Ensure the Lens Locking Knob is loose so a lens can be inserted.
2. Align the Aligning Pin with the V-shaped cutout on the Spotlight SE, and slide in the lens slightly.
3. Rotate the lens clockwise until it stops.
4. The lens is now engaged. Slide it into a desired position and tighten the Lens Locking Knob to fix it in place.

Removing:

1. Loosen the Lens Locking Knob while holding the lens in its position.
2. Start pulling the lens out of the Spotlight SE until it comes to a stop.
3. Rotate the lens counterclockwise until the V-shaped cutout is aligned with the Aligning Pin and pull out the lens completely.

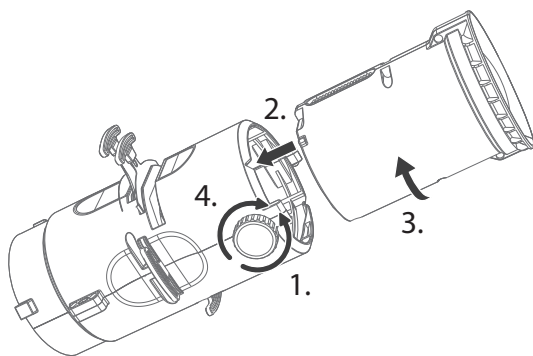

Installing

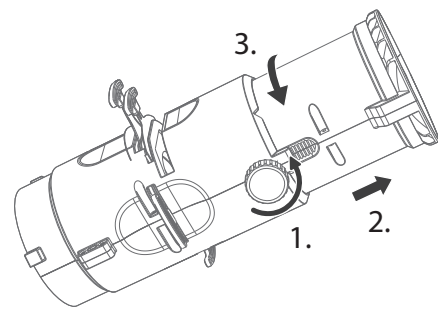

Removing

Installing and Removing Spotlight SE

Before installing the Spotlight SE on a lamp head, ensure the lens on the Spotlight SE is tightened securely (if there is one installed).

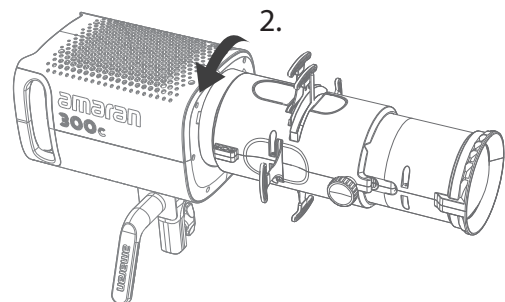
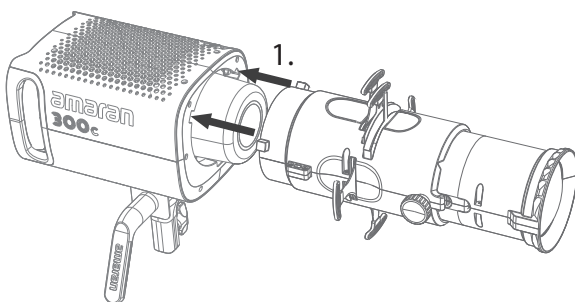

Note: Ensure the lighting fixture is turned off before installing/removing the Spotlight SE.

Installing and Removing Spotlight SE Gobo Holder

Installing:

1. Put the M size gobo of choice into the Gobo Holder as shown below, ensuring the correct orientation of the pattern.
2. Insert the Gobo Holder into Spotlight SE, in the narrow opening immediately in front of the Top Shutter.
3. Adjust the lens position to achieve desired focus of the projected pattern.

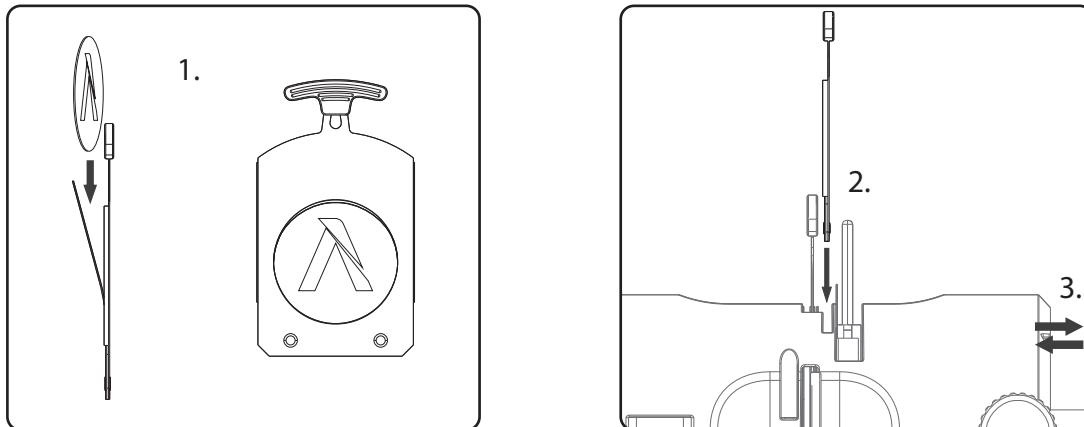

Removing:

1. Ensure the Spotlight SE has cooled down enough to safely remove the Gobo Holder.
2. Pull the Gobo Holder out of Spotlight SE, grabbing its plastic handle.
3. Take the M size gobo out of the Gobo Holder in the reverse order of the direction shown in the installation illustration and store the M size gobo and the Gobo Holder in the dedicated compartments in the carrying case.

Note: The components of this product may deform slightly or experience other issues such as smoke or discoloring after being exposed to high temperatures. These are expected behavior. Melting of any plastic parts or excessive amount of smoke can be deemed abnormal.

WARNING

When a gobo is just taken out of the Gobo Holder, do not place it near flammable or explosive objects, as it may be very hot and cause ignition.

Four-Leaf Shutter Operation

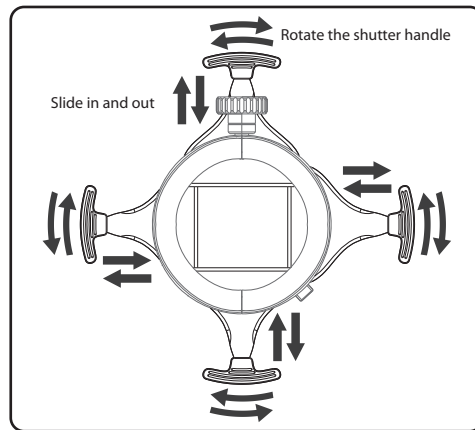

Spotlight SE has 4 shutters allowing users to precisely shape the light beam. Each shutter can be adjusted independently by rotating or sliding them within their range of motion.

Installing Spotlight SE Iris (sold separately)

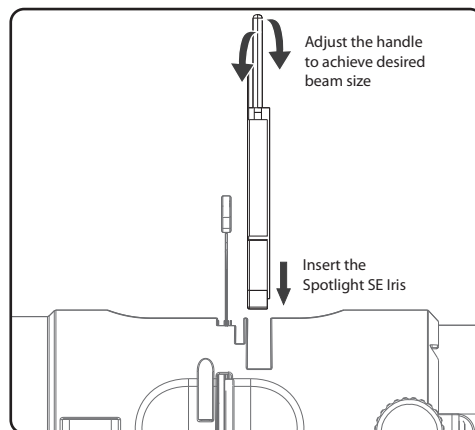

1. Insert the Iris in the designated slot.
2. Adjust the the position of the Iris handle to close down the aperture and achieve the desired beam effect.

Reusable Packaging and Optional Soft Case

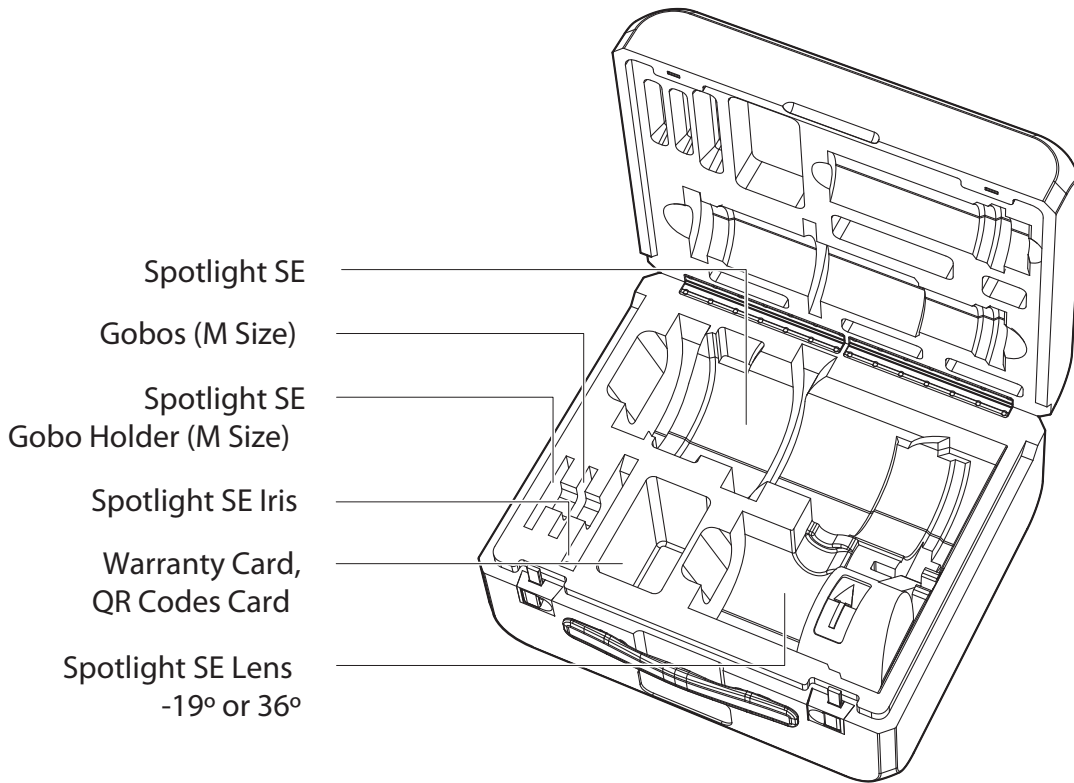

**EPP Foam
Reusable Packaging**

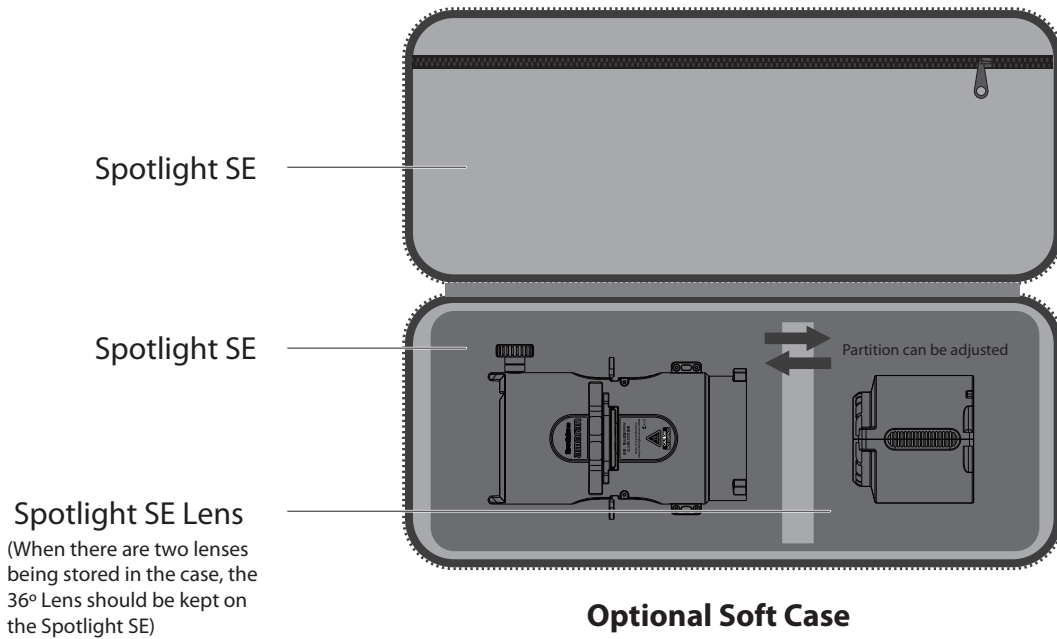

**Optional Soft Case
(sold separately)**

Specifications and Photometrics

Specifications

	Product Size	Net Weight
Spotlight SE (19° Lens Kit)	26.8 x 14.6 x 14.0cm / 10.55 x 5.75 x 5.5in	1.59kg / 3.5lb
Spotlight SE (36° Lens Kit)	21.5 x 14.6 x 14.0cm / 8.46 x 5.75 x 5.5in	1.30kg / 2.9lb

Photometrics - mounted on amaran 150c

CCT	Distance (m)	Spotlight SE (19° Lens)	Spotlight SE (36° Lens)
2,500K	1	18,740 lux	6,150 lux
	3	2,048 lux	636 lux
	5	752 lux	215 lux
3,200K	1	20,470 lux	6,680 lux
	3	2,230 lux	690 lux
	5	816 lux	250 lux
4,300K	1	22,160 lux	7,210 lux
	3	2,477 lux	899 lux
	5	906 lux	294 lux
5,600K	1	22,330 lux	7,260 lux
	3	2,486 lux	901 lux
	5	913 lux	286 lux
7,500K	1	23,910 lux	7,760 lux
	3	2,580 lux	794 lux
	5	938 lux	287 lux

Photometrics - mounted on amaran 300c

CCT	Distance (m)	Spotlight SE (19° Lens)	Spotlight SE (36° Lens)
2,500K	1	21,750 lux	7,390 lux
	3	2,455 lux	790 lux
	5	917 lux	250 lux
3,200K	1	23,940 lux	8,110 lux
	3	2,662 lux	860 lux
	5	1,007 lux	318 lux
4,300K	1	26,540 lux	8,980 lux
	3	3,150 lux	1,025 lux
	5	1,067 lux	352 lux
5,600K	1	28,560 lux	9,620 lux
	3	3,380 lux	1,098 lux
	5	1,149 lux	378 lux
7,500K	1	27,230 lux	9,140 lux
	3	2,910 lux	950 lux
	5	1,141 lux	360 lux

Beam uniformity charts

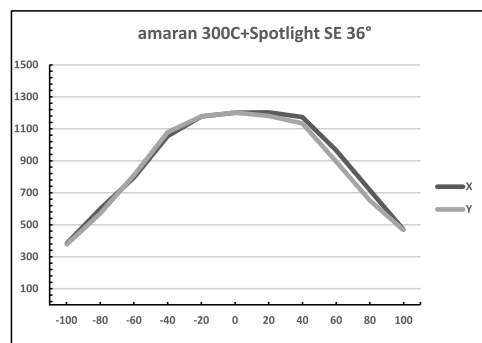
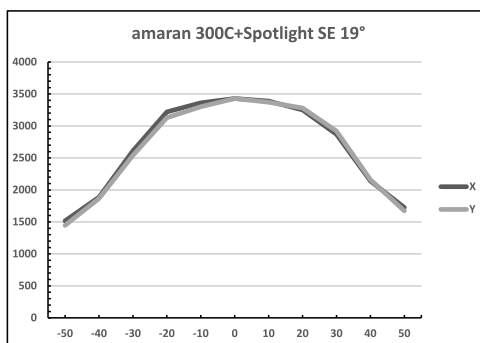
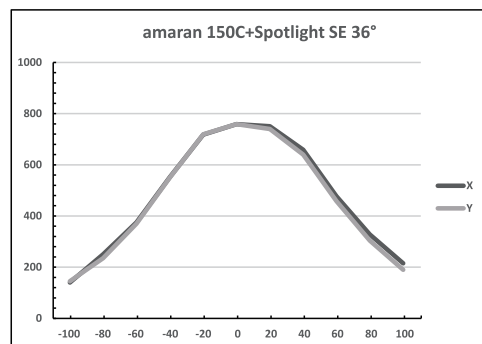
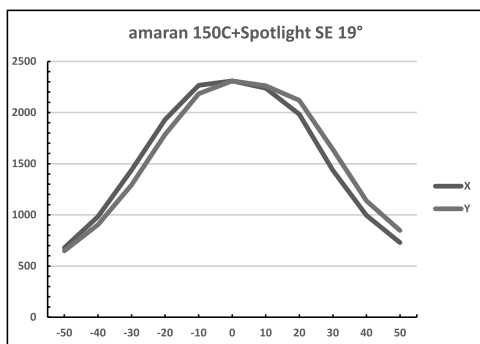

Trademarks

Bowens is a trademark registered by Bowens in China and other countries.

DISCLAIMER

Before using this product, please read the user manual to ensure correct use under the complete understanding. After reading, keep the product manual properly for future reference. In case of not operating this product correctly, it may seriously harm yourself or others, or result in product damage and property loss. When using this product, it shall be deemed that you have understood, recognized, and accepted all clauses and contents of this document. The user commits to be responsible for their own behaviors and all consequences thereof. Aputure shall not be liable for any loss due to the user not using this product in accordance with the product manual.

Under the laws and regulations, our company holds the final explanation right of this document and all related documents of this product. No prior notice will be given for any updates, revision, or termination. Please visit the official Aputure website for the latest product information.