

amaran®

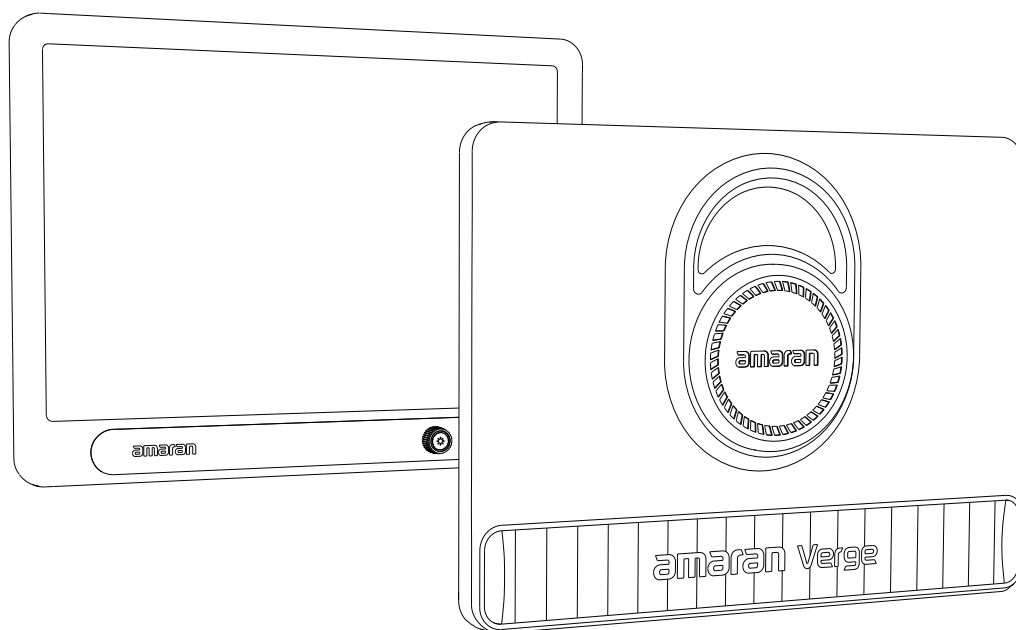

amaran Verge Product Manual

English

Content

Introduction.....	03
Components List.....	04
Product Overview.....	05
Operations	06
1. Power Supply and Power On/Off.....	06
2. Adjusting INT and CCT	06
3. Bluetooth Reset.....	07
4. FX Mode	07
5. Studio Mode	07
6. Firmware Upgrade	07
7. Light Installation	07
Using the amaran App	11
Specifications	12
Photometrics	13
Important Safety Instructions	14
FCC Compliance Statement.....	15
RF Warning Statement.....	15
Disclaimer	16

Introduction

Thank you for purchasing the amaran Verge. Designed for desktop creators, the amaran Verge is a soft, edge-lit LED panel with 25W of power output. Whether you're live-streaming or recording videos, the amaran Verge delivers soft, even lighting with an adjustable color temperature range and accurate tones to match any mood or scene.

Whether controlled via the amaran desktop app, Stream Deck, or its front-facing controls, you can easily make quick brightness and color temperature adjustments without stepping out of frame. The amaran Verge Lock allows for quick and easy mounting onto your desk or a table stand, while its RGO certification can sustain long content creation sessions without eye strain.

Components List

Please make sure all accessories listed below are complete before using. If not, please contact your sellers immediately.

amaran Verge (Base Version)

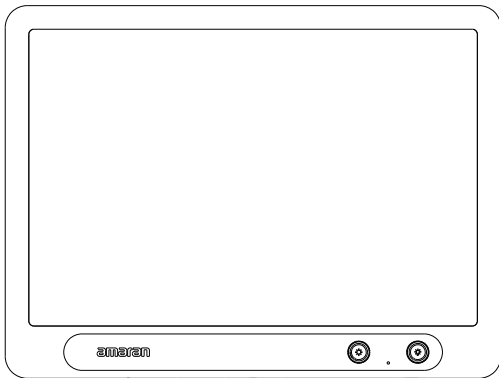

amaran Verge*1

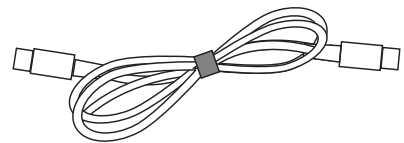

amaran USB-C Charging Cable (1.5m)*1

amaran Verge

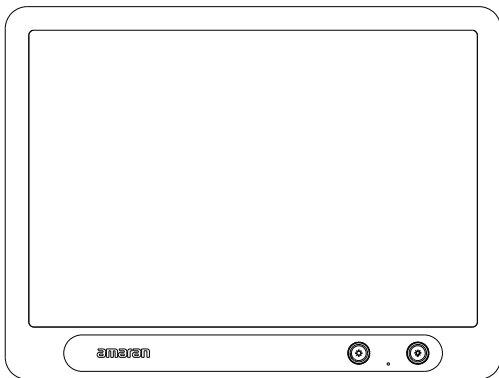

amaran Verge*1

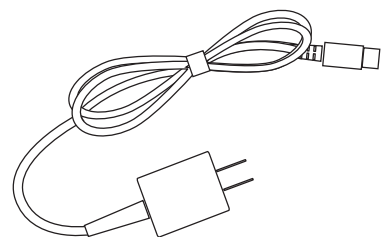

amaran 30W PD Power Adapter *1

Tip: The illustrations in the manual are diagrams for reference only. Due to the continuous development of new versions of the product, if there are any differences between the product and the user manual diagrams, please refer to the product itself.

Product Overview

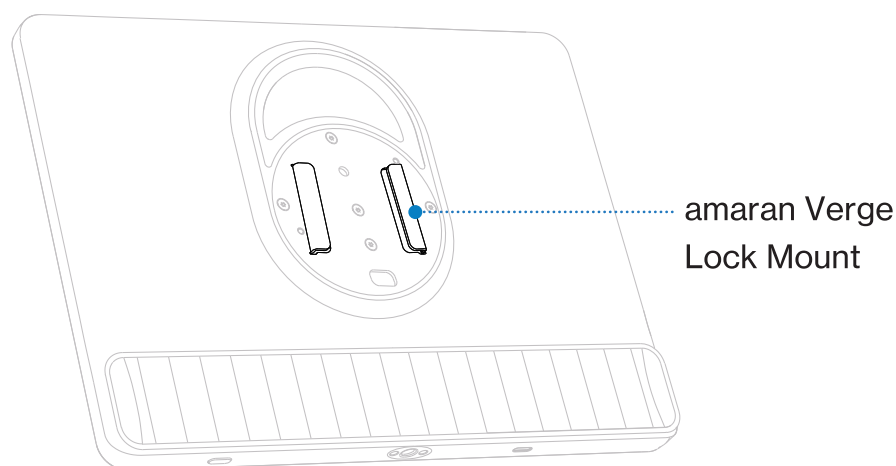
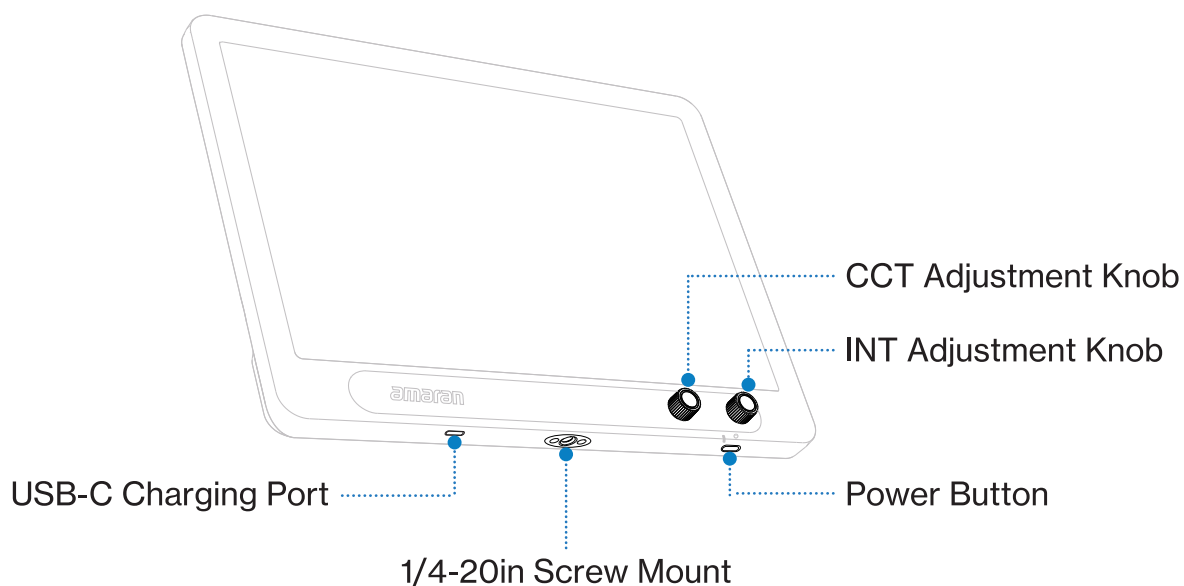

Power Button	Press to turn the light on/off. Hold 2s to reset Bluetooth. Double click to toggle Studio Mode on/off.
INT Adjustment Knob	Rotate to adjust the light's brightness.
CCT Adjustment Knob	Rotate to adjust the light's color temperature.
1/4-20in Screw Mount	Mount the light onto 1/4-20in tripods, light stands, or other equipment.
USB-C Charging Port	Used to charge the fixture via a PD-supported power supply.
amaran Verge Lock Mount	Use the light with amaran Verge Lock compatible accessories. The protective cover must be removed before use.

Operations

1. Power Supply and Power On/Off

1. Use the included amaran USB-C PD Power Adapter to supply power to the light. Plug the end of the Power Adapter into the USB-C Charging Port, located on the bottom of the light. The indicator light will automatically light up after plugging in.

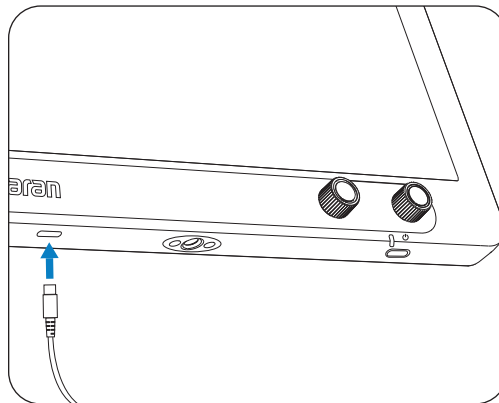

2. After connecting to the power supply, press the power button on the bottom of the fixture to turn the light on. The light will resume to its previous settings prior to turning off.

3. Press the power button again to turn the light off.

**Note: The amaran Verge supports power supply standards of USB PD3.0, but is not compatible with some third-party private charging protocols. Please ensure to select the appropriate power supply device.*

2. Adjusting INT and CCT

1. INT (Intensity):

Rotate the INT adjustment knob to adjust your light's brightness from 0%-100%.

2. CCT (Correlated Color Temperature):

Rotate the CCT adjustment knob to adjust your light's CCT from warm white (2,700K) to cool white (6,500K).

**Note: To fine-tune your lighting even further by dialing in exact values, please use the amaran app.*

3. Bluetooth Reset

1. Bluetooth is turned on by default.
2. When the light is turned on, press and hold the power button for 2 seconds to reset Bluetooth. The indicator light will flash then turn off, completing the Bluetooth reset.

4. FX Mode

FX Mode is enabled via the amaran app. The amaran Verge supports 7 lighting effects via the amaran app:

Fireworks	Faulty Bulb	Lightning	TV	Strobe	Explosion	Fire
-----------	-------------	-----------	----	--------	-----------	------

5. Studio Mode

When the light is turned on, double-click the power button to toggle Studio Mode on/off. The indicator light will light up for 2 seconds then turn off.

Studio Mode is turned off by default.

6. Firmware Upgrade

Firmware updates can be updated online via the amaran app or Sidus Link.

7. Light Installation

Installation Method 1: Install with the amaran Desk Stand*

1. Rotate to tighten the adjustable column into the base plate.

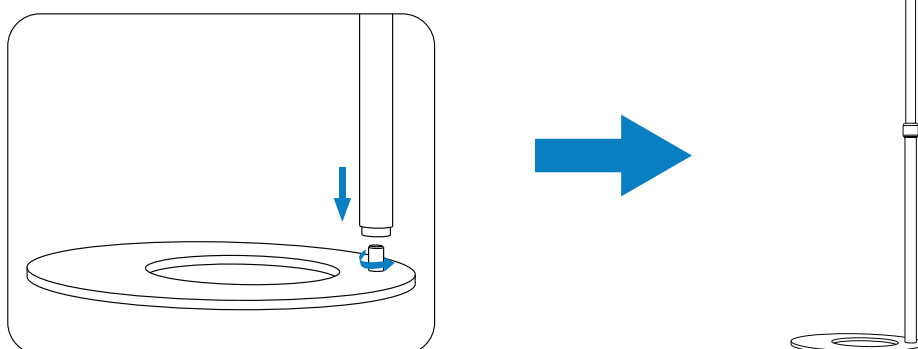

2. Place the amaran Desk Stand onto a stable and flat surface.
3. The amaran Desk Stand features 1/4-20in screw threads. Align the 1/4-20in screw mount at the bottom of the light to the 1/4-20in screw threads and locating pins on the desk stand. Rotate the locking wheel to secure the light.

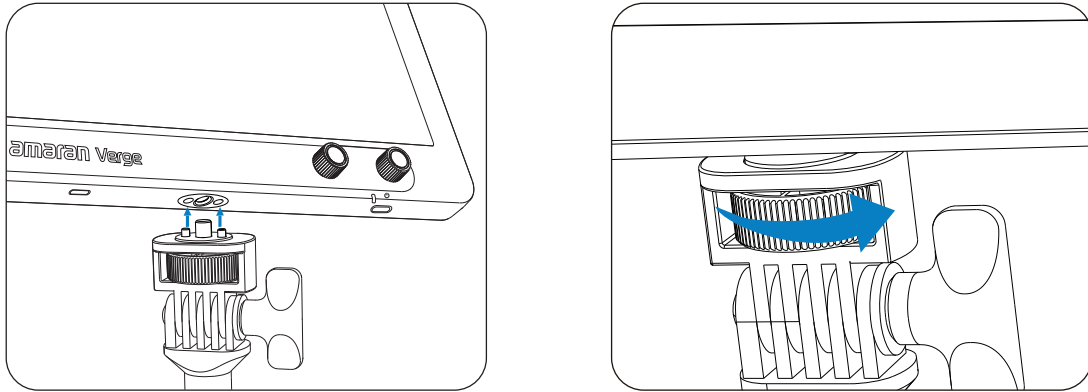

4. Once the amaran Desk Stand is securely installed, adjust the angle and height of the light.
- *Note: The amaran Desk Stand is sold separately.*

Installation Method 2: Install with the amaran Verge Lock Desk Clamp Stand

1. Before installation, please ensure that your desk or mounting surface is between 2-7cm (0.79-2.75in) thick in order for the desk clamp stand to be installed securely.
2. Clamp the base onto the desktop and rotate the locking screw to secure it.

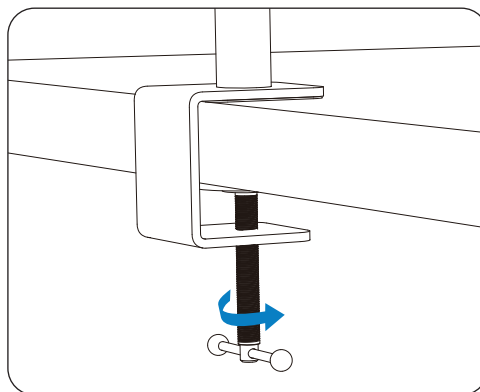

3. Connect the two columns via the screws and tighten to secure.

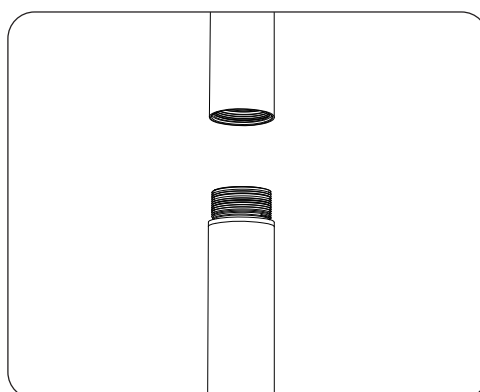

4. Insert the horizontal mounting arm onto the vertical column to your desired position. Tighten to secure. When inserting the mounting arm, please ensure the protruding side of the arm is facing downwards.

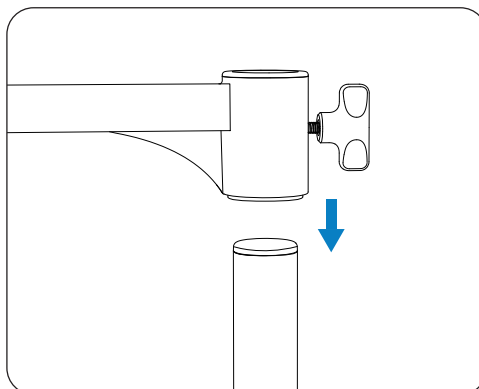

5. The desk clamp stand mounts to the back of the light via the amaran Verge Lock. Remove the amaran Verge Lock protective cover. Align the back of the light with the amaran Verge Lock on the mounting arm, and gently insert the amaran Verge in place. The amaran Verge Lock should automatically snap securely into place.

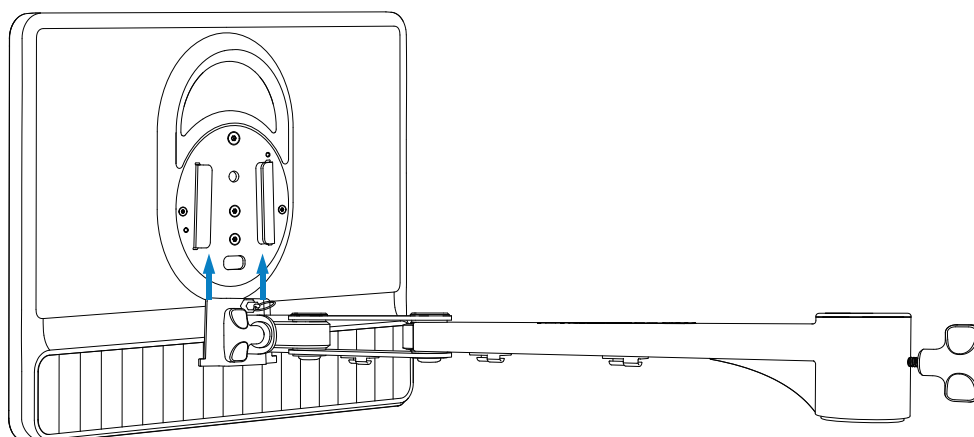

**Note: The amaran Verge Lock Desk Clamp Stand is sold separately.*

Installation Method 3: Install with the amaran Verge Lock Stand Adapter

1. Insert the bottom of the amaran Verge Lock Stand Adapter onto a light stand. Insert and lock the tie down to secure. You can install the amaran Verge Lock Stand Adapter horizontally or vertically for different setups.

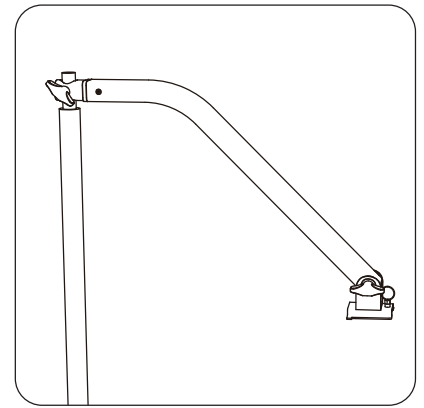
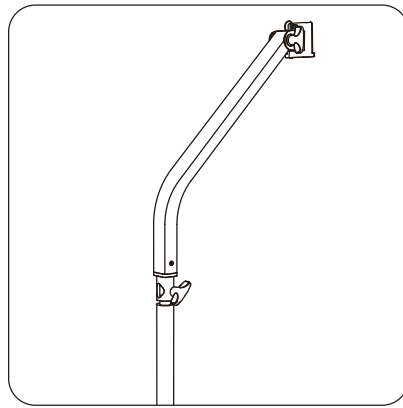
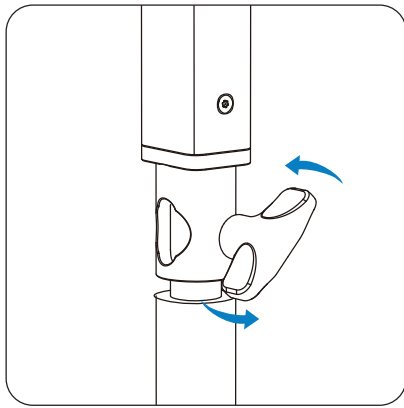

2. The stand adapter mounts to the back of the light via the amaran Verge Lock. Remove the amaran Verge Lock protective cover. Align the back of the light with the amaran Verge Lock on the stand adapter, and gently insert the amaran Verge in place. The amaran Verge Lock should automatically snap securely into place.

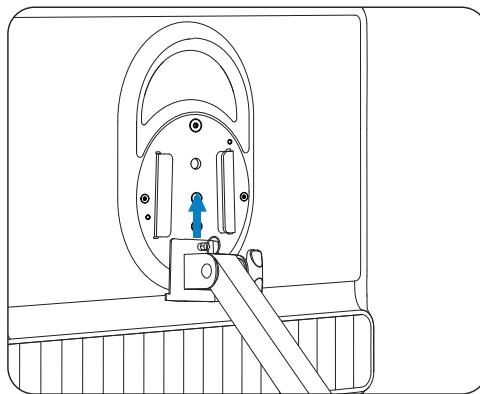

3. Rotate the tilting bracket knob to adjust the angle and height of the light.

**Note: The amaran Verge Lock Stand Adapter is sold separately.*

Using the amaran App

You can download the amaran mobile app from the iOS App Store, Google Play Store, and other platforms for enhancing the functionality of the light. You can download the amaran desktop app for Mac and Windows from the amaran website. Please visit amarancreators.com for more details on how to use the app to control your amaran lights.



amaran APP



amarancreators.com

Specifications

Power Input(max)	30W	Power Output(max)	26W
CCT	2,700K - 6,500K	Lumens	2,347 lumens
CRI	96	TLCI	97
TM-30 Rg	101	TM-30 Rf	93
SSI (D32)	82	SSI (D56)	73
Wireless Operating Range (Bluetooth)	≤100m / 328ft	Power Specifications	PD3.0 20V
Operating Temperature	-10°C ~40°C 14°F - 104°F	Storage Temperature	-20°C ~80°C -4°F - 176°F
Control Methods	On-Board, amaran App, Sidus Link	Firmware Upgrade Method	amaran App, Sidus Link
Adapter Input Voltage	110V~220V	Length of Adapter Wire	1.8m / 5.9ft
Fixture Weight	0.94kg / 2.1lbs	Cooling Method	Passive Cooling
Fixture Dimensions	29.3*22.1*2.8cm 11.5*8.7*1.1in		

Photometrics

CCT	Distance	No Accessories
2,700K	0.5m	2,603 lux
		242 fc
	1m	683 lux
		63 fc
3,200K	0.5m	2,860 lux
		266 fc
	1m	756 lux
		70 fc
4,300K	0.5m	3,160 lux
		294 fc
	1m	830 lux
		77 fc
5,600K	0.5m	3,150 lux
		293 fc
	1m	822 lux
		76 fc
6,500K	0.5m	3,060 lux
		284 fc
	1m	797 lux
		74 fc

Important Safety Instructions

When using the amaran Verge, basic safety precautions should always be followed, including the following:

1. Read and understand all instructions before using.
2. Please have the product checked by an authorized service personnel agent if the product has a problem. Any malfunctions caused by unauthorized disassembly are not covered by the warranty. The user may pay for maintenance.
3. Please do not place the fixture in high temperature environments for long periods of time, as it will accelerate the aging of the product or cause distortion to the panel.
4. Close supervision is necessary when any fixture is used by or near children. Do not leave the fixture unattended while in use.
5. Do not operate the fixture if a cord is damaged, or if the fixture has been dropped or damaged, until it has been examined by qualified service personnel.
6. This fixture is not waterproof. Please do not use the light fixture in wet conditions on account of electric shock may be caused.
7. When using the fixture for long periods of time in high temperature environments above 40°C / 104°F, care must be taken as burns can occur from touching hot surfaces.
8. Please do not place the unit near any flammable object.
9. Avoid rotating the light and ensure that the control knobs are at the bottom to prevent damage or the fixture from falling accidentally.
10. We recommend only using the original amaran Power Adapter. Please note that any malfunctions caused by using unauthorized accessories are not covered by the warranty. The user may pay for maintenance.
11. This product is certified by ROHS inspection report. Please operate the product in full compliance with relevant country's standards. Any malfunctions caused by incorrect use are not covered by warranty. The user may pay for maintenance.
12. The instructions and information in this manual are based on thorough, controlled company testing procedures. Further notice will not be given if the design or specifications change.

FCC Compliance Statement

WARNING

Changes or modifications not expressly approved by the party responsible for compliance could void the user's authority to operate the equipment.

NOTICE

This equipment has been tested and found to comply with the limits for a Class B digital device, pursuant to Part 15 of the FCC Rules. These limits are designed to provide reasonable protection against harmful interference in a residential installation. This equipment generates, uses, and can radiate radio frequency energy and, if not installed and used in accordance with the instructions, may cause harmful interference to radio communications. However, there is no guarantee that interference will not occur in a particular installation.

If this equipment does cause harmful interference to radio or television reception, which can be determined by turning the equipment off and on, the user is encouraged to try reorient or relocate the receiving antenna.

- Increase the separation between the equipment and receiver.
- Connect the equipment to an outlet on a different circuit than the receiver is connected to.
- Consult the dealer or an experienced radio/TV technician for help.

RF Warning Statement:

This device has been evaluated to meet general RF exposure requirements.

Disclaimer

It is important to read the product manual of this product prior to use in order to ensure proper use with a complete understanding. The product manual should be securely stored for future reference after reading. Improper operation of this product may result in severe personal injury to yourself or others, as well as potential damage to the product and loss of property. As soon as you use the product, you are deemed to have understood, recognized and accepted all the terms and contents of the product manual. Users assume responsibility for their own conduct and any resulting consequences. amaran is not liable for any damages suffered as a result of the user's failure to use the product in accordance with product manual.

Please visit the official amarancreators.com website for the latest product information.