

amaran[®]

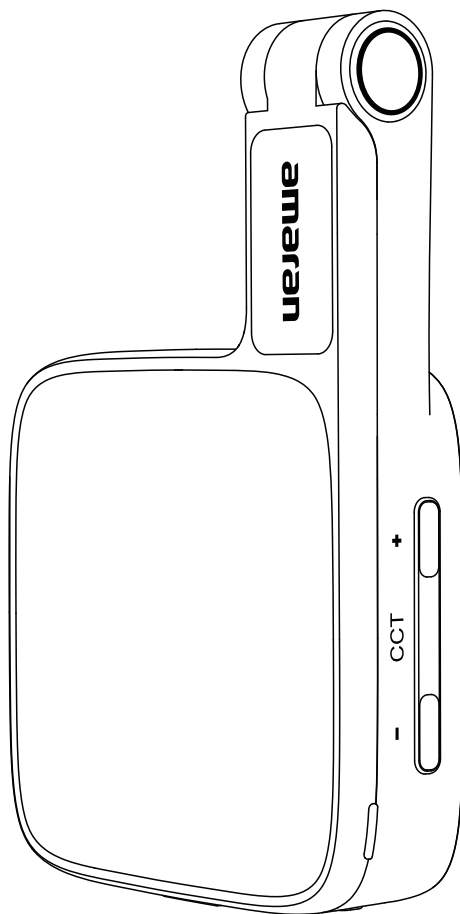

amaran Go

Product Manual

English

Table of Content

Introduction.....	03
Components List.....	04
Product Overview	05
Operations.....	06
1. Setting Up Your Light.....	06
2. Powering On/Off	08
3. Adjusting Your Brightness Levels	08
4. Adjusting Your Color Temperature (CCT).....	09
5. Switching Between the Main Light and Mirror Light	09
6. Bluetooth Reset.....	10
7. Triggering SOS Flash	10
8. Indicator Light	11
Firmware Upgrade.....	11
Using the amaran App.....	12
Photometrics.....	12
Specifications	13
Important Safety Instructions	14
FCC Compliance Statement	15
RF Warning Statement.....	15
Disclaimer	16

Introduction

Thank you for purchasing the amaran Go. Designed for mobile content creators, the amaran Go is a MagSafe-compatible mini phone light that provides a fast and secure light source that snaps directly to your phone in less than a second. Its versatile flip design grants lighting flexibility whether creating content with your front or rear camera – flip it open when filming vlogs or taking selfies, or collapse it for filming your surroundings or other subjects. The amaran Go also doubles as your portable beauty companion with a second light, featuring a makeup mirror with built-in lighting for quick touch ups.

Components List

Please make sure all accessories listed below are completed before using.

If not, please contact your sellers immediately.



amaran Go x1



MagSafe Adapter Sticker x1

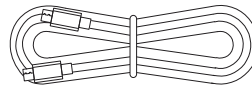

amaran USB-C Charging Cable (50cm)x1

**Tips: The illustrations in the manual are only diagrams for reference. Due to the continuous development of new versions of the product, if there are any differences between the product and the user manual diagrams, please refer to the product itself.*

Product Overview

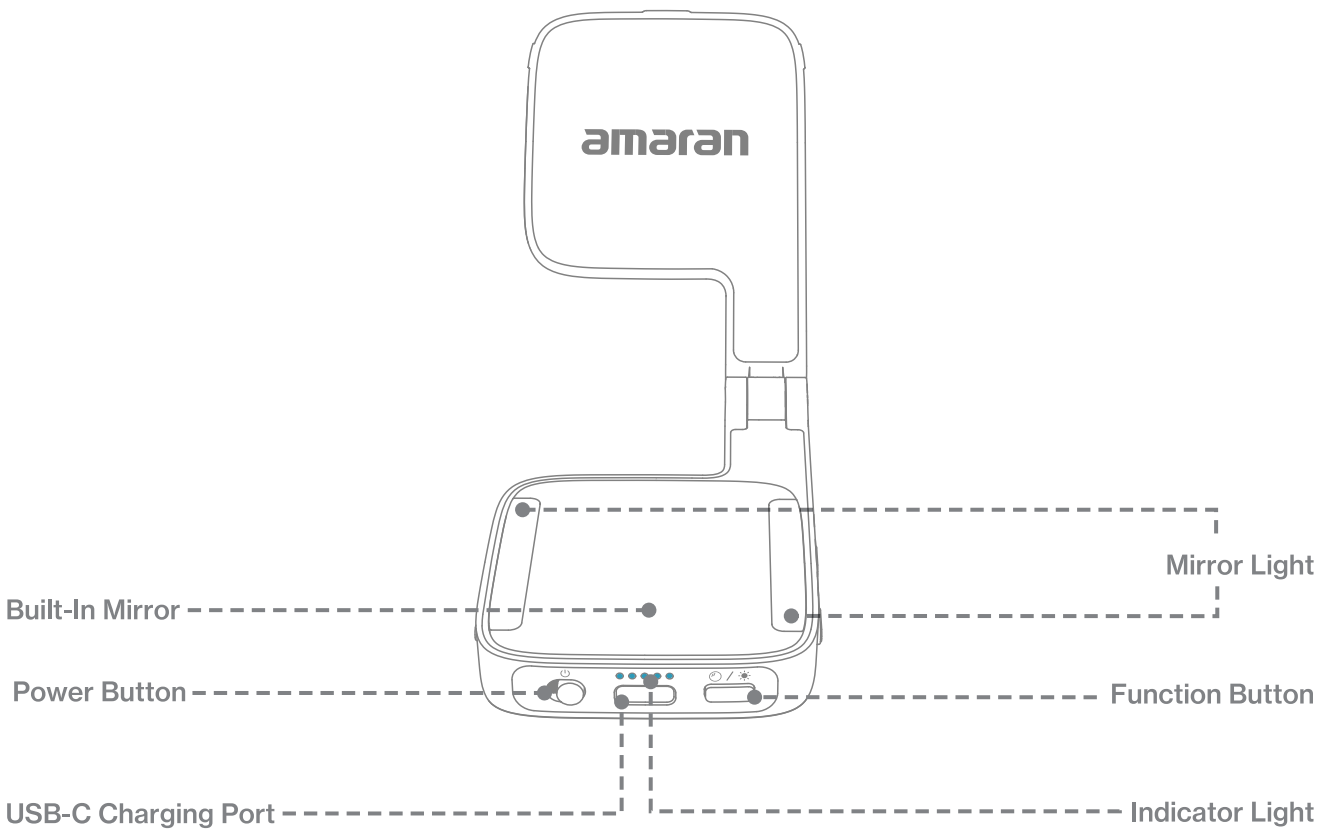
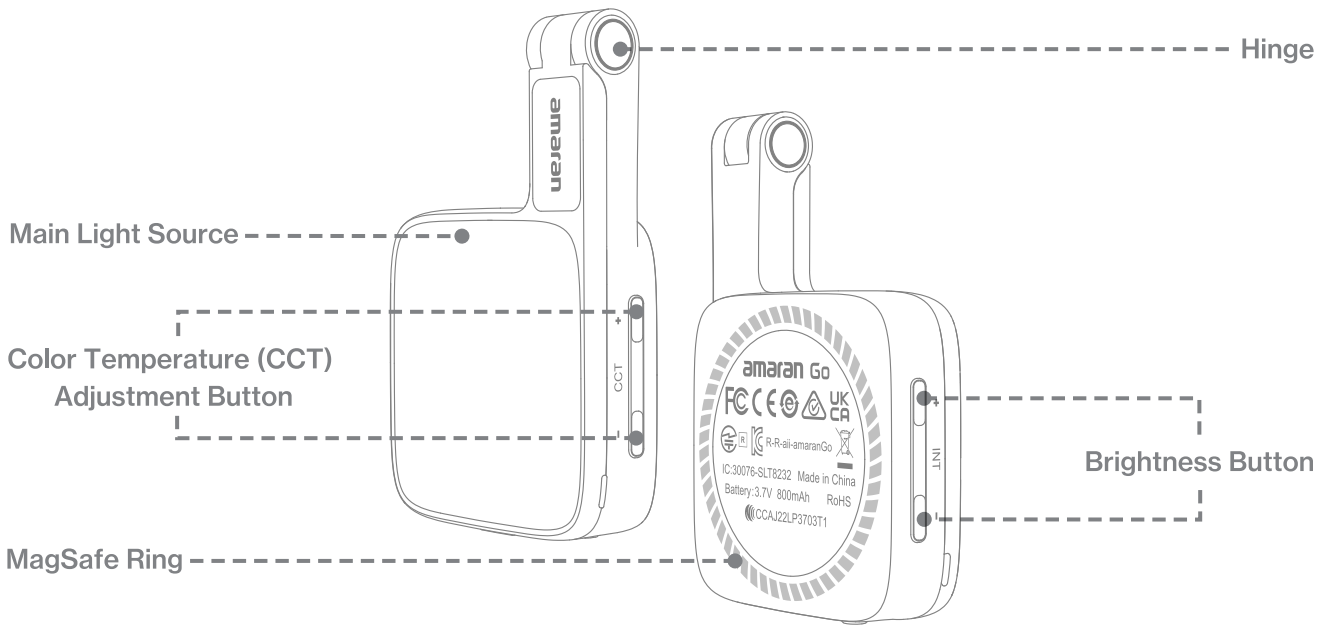

Operations

1. Setting Up Your Light

As a MagSafe and Qi2 magnetic mount compatible light, the amaran Go can be securely attached to a compatible phone in less than a second without additional tools.

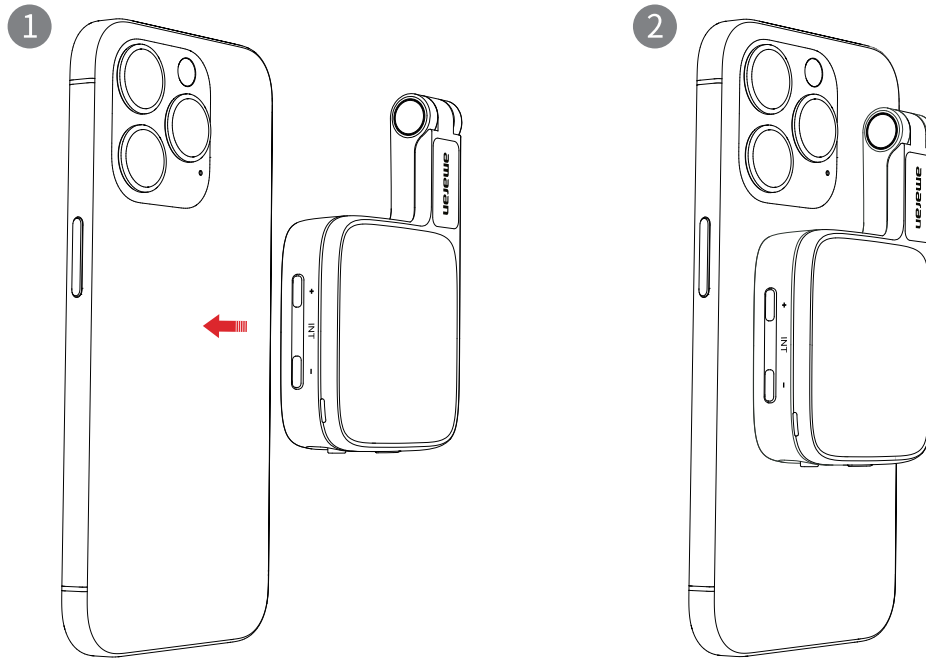

An amaran MagSafe Sticker is included for use with non-MagSafe compatible devices and laptops.

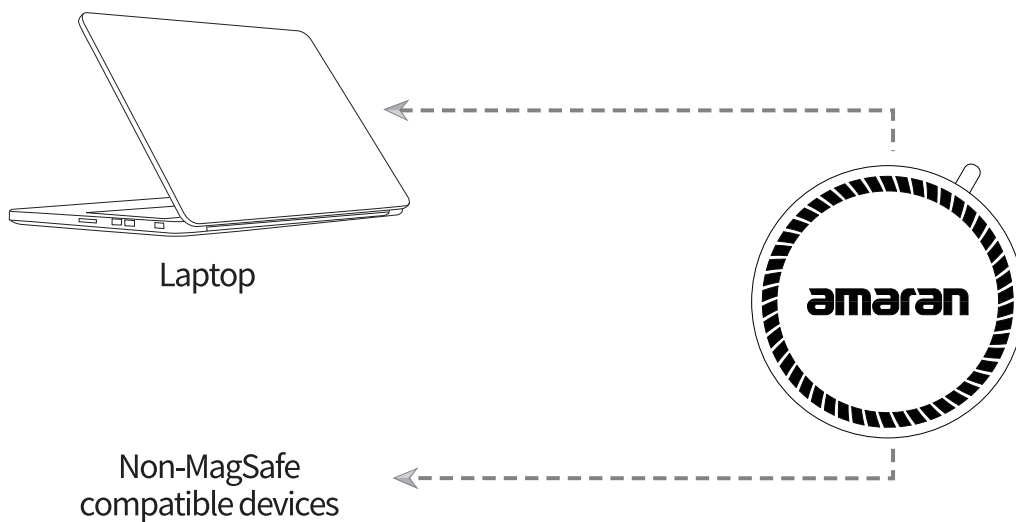

- ① Remove the protective film on the back of the MagSafe Sticker;
- ② Place it onto your desired mounting surface;
- ③ Press the sticker down for 10 seconds to ensure it is firmly attached, and you can snap your light and start creating.

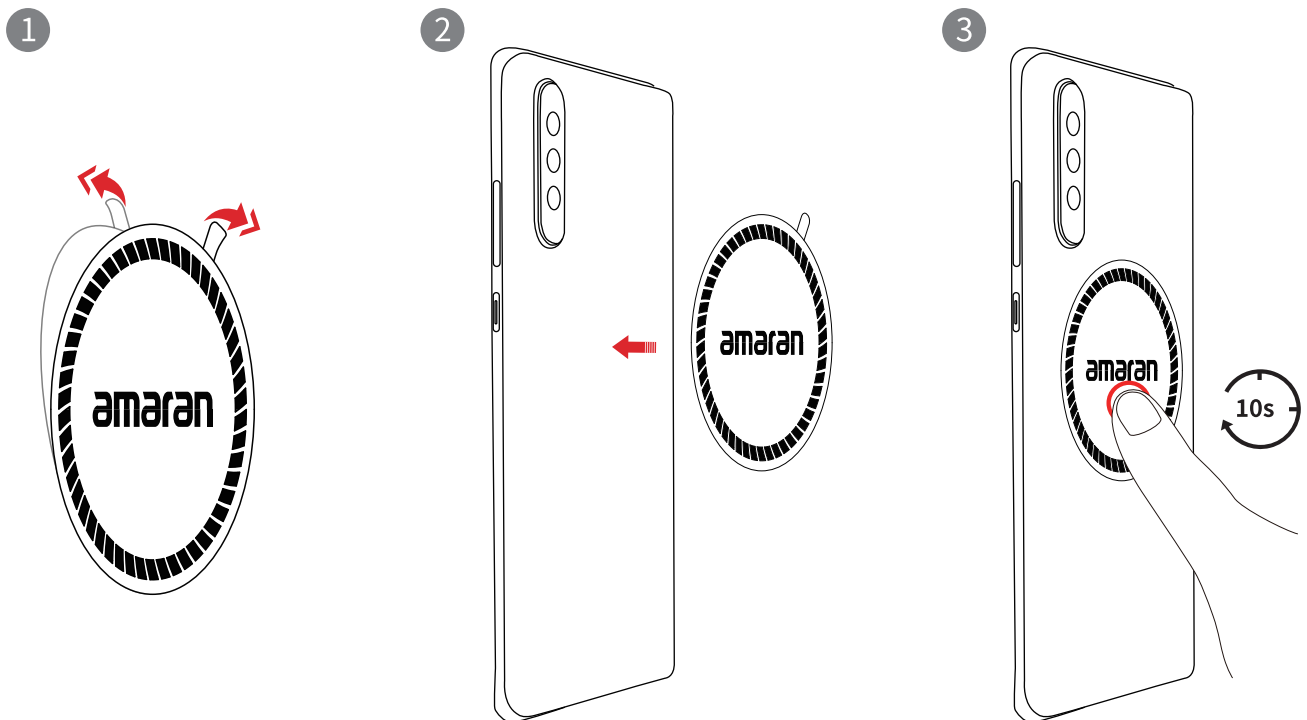

When filming content with your front camera, flip the amaran Go open and ensure the main light is facing forward for the best results.

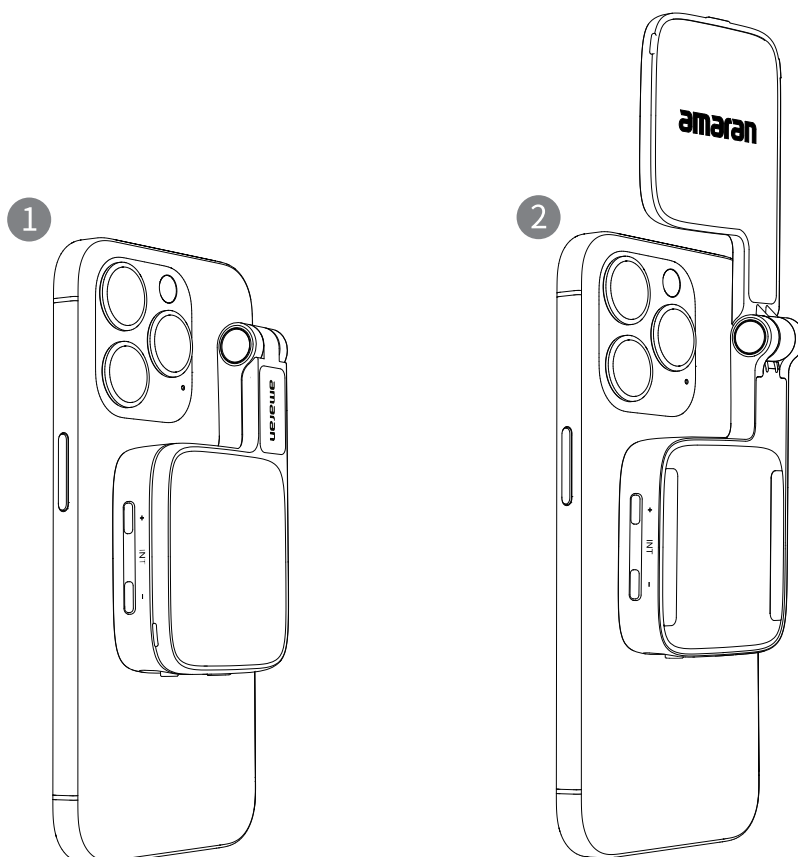

2. Powering On/Off

The power button is located on the bottom of the light. Toggle the power button to the right to power on, and toggle to the left to power off.

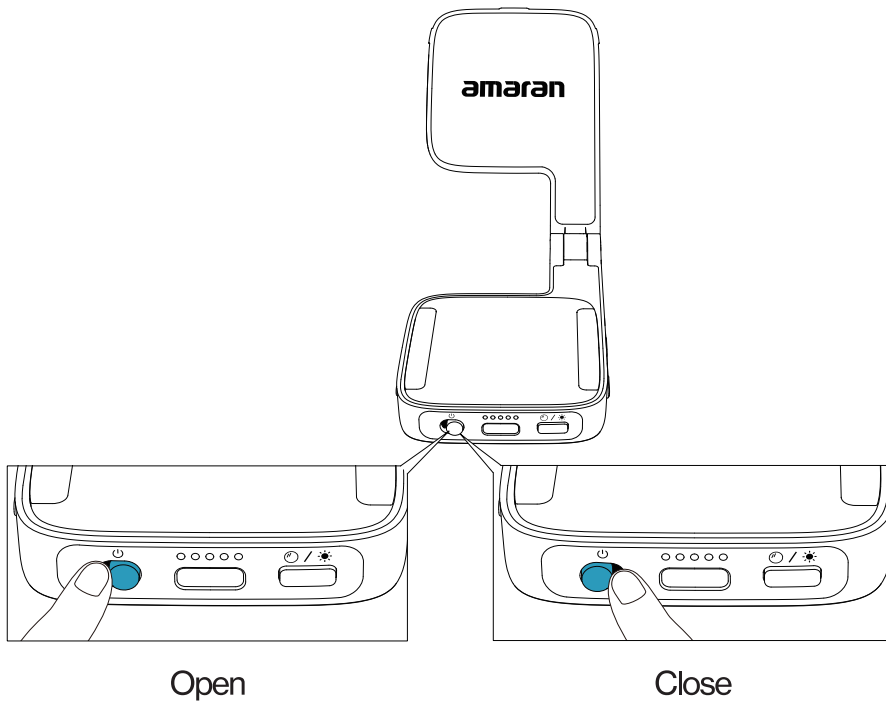

3. Adjusting Your Brightness Levels

There are a total of 10 brightness settings, from 10% to 100%.

Press the + or - buttons to increase or decrease your light's brightness in 10% increments. Holding the + or - buttons will adjust your light's brightness to the minimum (10%) or the maximum (100%) level.

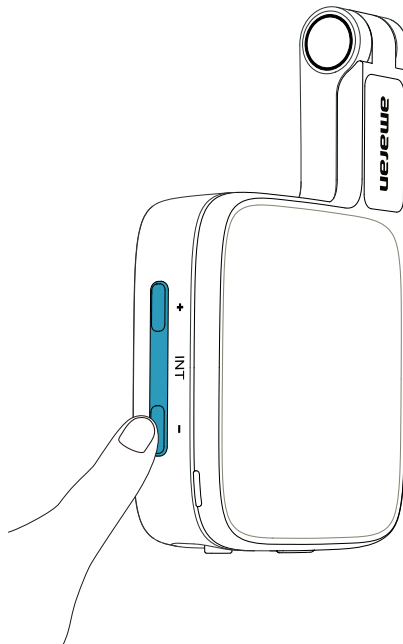

4. Adjusting Your Color Temperature (CCT)

There are a total of 10 adjustable light modes, from warm white to cool white.

Press the + button to increase your light's color temperature to a cooler white, or press the - button to decrease to a warmer white.

Holding the + or - buttons will adjust your light's color temperature to the warmest setting (2,700K CCT) or coolest setting (6,500K CCT).

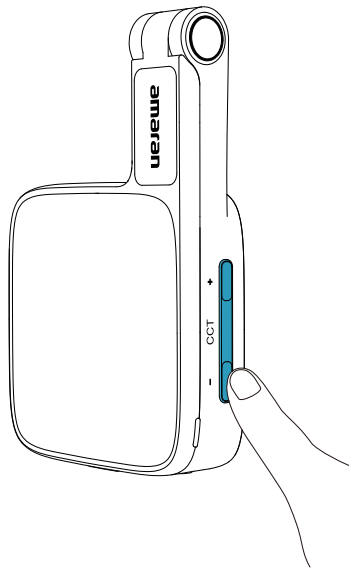

5. Switching Between the Main Light and Mirror Light

The amaran Go is the first dual portable light, featuring a main light source and a built-in mirror light for quick touch ups. Press the Function button to switch between the two light sources.

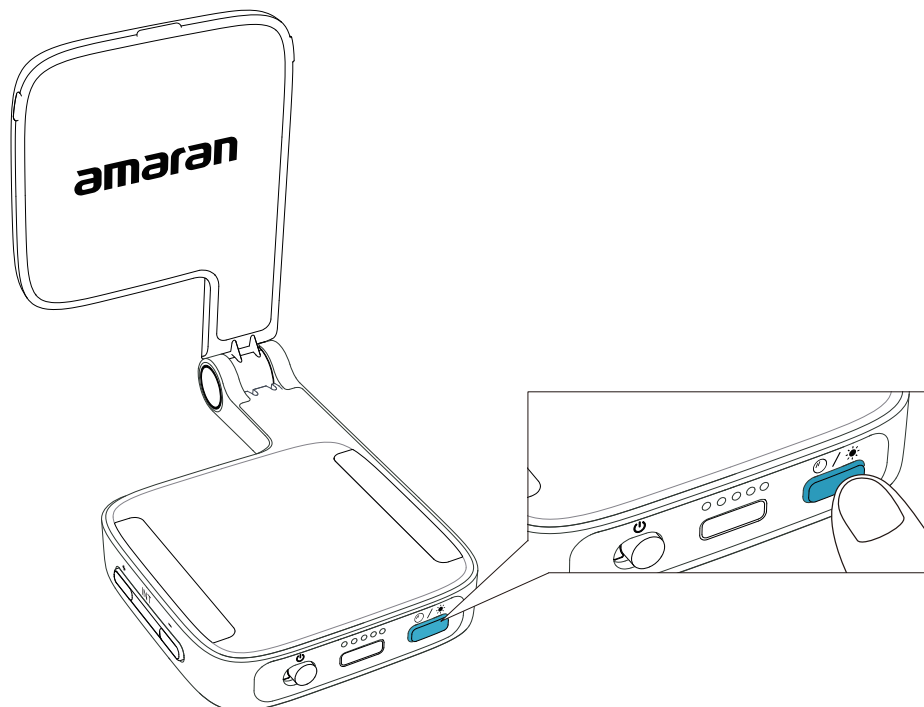

6. Bluetooth Reset

- ① Hold the Function button for 2 seconds to reset your Bluetooth and connect your light to the amaran app.
- ② Bluetooth reset is successful when the indicator light flashes 5 times.

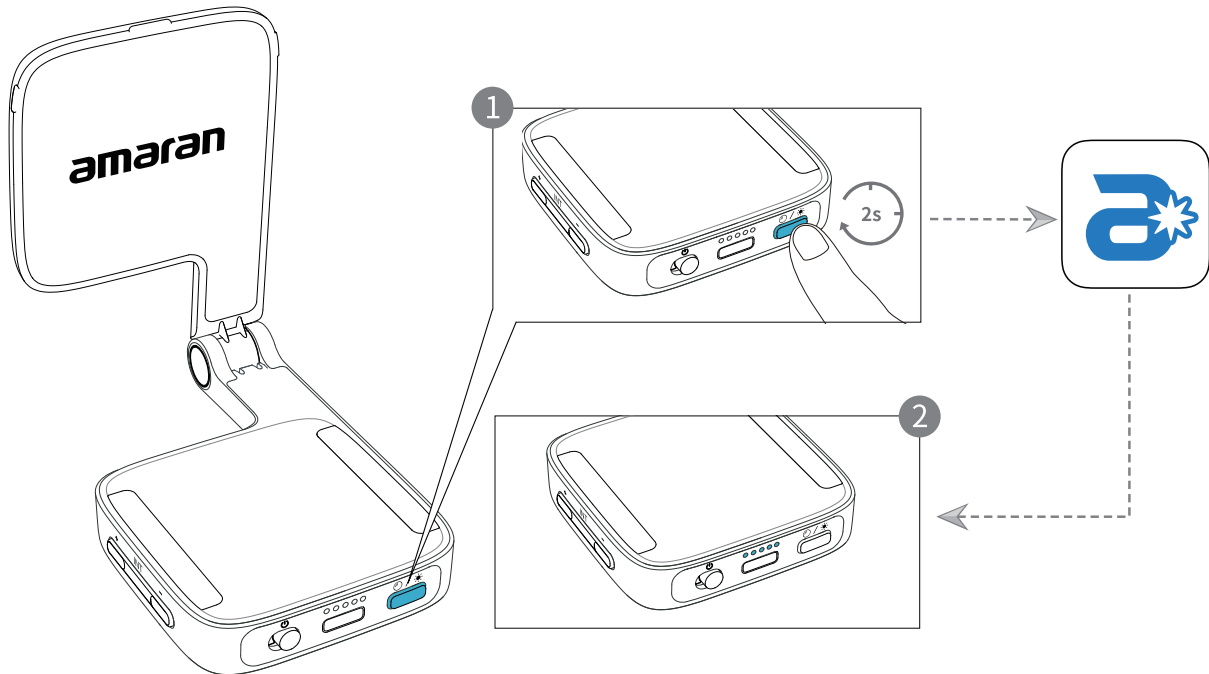

7. Triggering SOS Flash

- ① Press the Function button twice to trigger the SOS light.
- ② When the SOS function is activated, the light will flash.

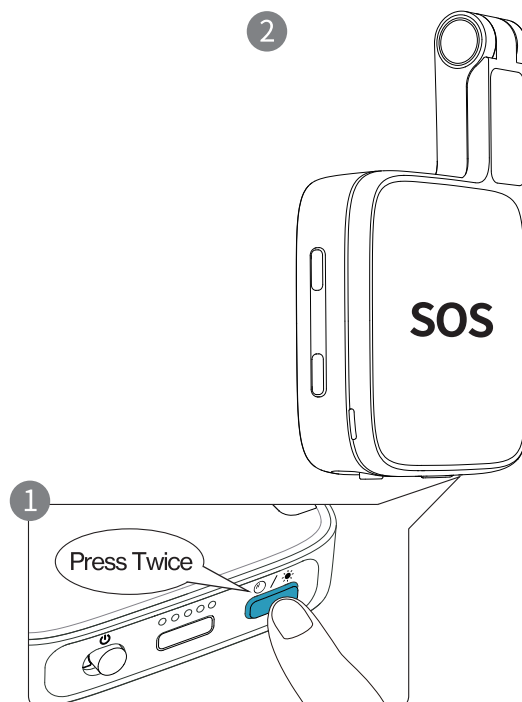

8. Indicator Light

When the light is powered on, the indicator light will display battery levels in 20% increments. An 80% battery level will display 4 lights. When the light is charging, the indicator lights will flash in order. Once it is fully charged, all 5 indicator lights will remain on.

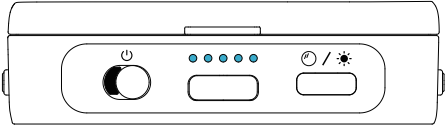
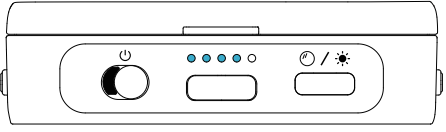
	
<p>100% Battery Level</p>	<p>80% Battery Level</p>
<p>When adjusting your light's brightness via the Intensity buttons:</p>	<p>When adjusting your light's color temperature via the CCT buttons:</p>
<p>There are a total of 10 brightness settings, from 10% to 100%.</p>	<p>There are a total of 10 adjustable light modes, from warm white to cool white.</p>
<ul style="list-style-type: none"> ● Each Flashing Light: 10% Brightness 	<ul style="list-style-type: none"> ● Each Flashing Light: 1 Level
<ul style="list-style-type: none"> ● Each Solid Light: 20% Brightness 	<ul style="list-style-type: none"> ● Each Solid Light: 2 Levels
<ul style="list-style-type: none"> ● All Indicator Lights On: 100% Brightness 	<ul style="list-style-type: none"> ● All Indicator Lights On: Coolest Setting (6,500K CCT)
<ul style="list-style-type: none"> ● 1 Flashing Light: 10% Brightness 	<ul style="list-style-type: none"> ● 1 Flashing Light: Warmest Setting (2,700K CCT)

Firmware Upgrade

Firmware updates can be updated online via the amaran app.

Using the amaran App

You can download the amaran mobile app from the iOS App Store, Google Play Store, and other platforms for enhancing the functionality of the light. You can download the amaran desktop app from the amaran website. Please visit amarancreators.com for more details regarding how to use the app to control your amaran lights.



Scan the QR code to download the amaran app



amarancreators.com

Photometrics

CCT	Distance	Main Light	Mirror Light
2,700K	0.5m	209 lux / 19 fc	/
3,200K		213 lux / 20 fc	/
4,300K		218 lux / 20 fc	/
5,600K		228 lux / 21 fc	95 lux /9 fc
6,500K		235 lux / 22 fc	/

Specifications

Max Power Output (Main Light)	2W(MAX)	Max Power Output (Mirror Light)	1W(MAX)
CCT	2700-6500K	CRI	97+
TLCI	99	Lumens	200 lm
CQS	96	TM-30 Rg (Average)	102
SSI (Tungsten)	83	SSI (D56)	73
Power Supply Specifications	USB Type-C	Wireless Operating Range	≤80m / ≤262.5ft (Bluetooth)
Operating Temperature	-10°C - 40°C / 14°F - 104°F	Storage Temperature	-20°C - 80°C / -4°F - 176°F
Control Methods	On-board, amaran App, Sidus Link	Firmware Upgradeable	amaran App, Sidus Link
Charge Time	Approx. 70 Mins (0%-100% Charge)	Cooling Method	Passive Cooling
Battery Capacity	800mAh	Battery Voltage	3.7V
Main Light Battery Runtime (100%)	Approx. 1 Hour 21 Mins	Main Light Battery Runtime (10%)	Approx. 8 Hours 50 Mins
Dimensions	9.0 x 5.8 x 1.6cm 3.54 x 2.28 x 0.63in	Weight	85g / 0.19lbs
USB-C Charging Cable Length	50cm / 1.64ft		

Important Safety Instructions

When using the amaran Go, basic safety precautions should always be followed, including the following:

1. Read and understand all instructions before using.
2. Close supervision is necessary when any fixture is used by or near children. Do not leave the fixture unattended while in use.
3. Care must be taken as burns can occur from touching hot surfaces.
4. Do not operate the fixture if a cord is damaged, or if the fixture has been dropped or damaged, until it has been examined by qualified service personnel.
5. Always unplug the USB-C Charging Cable from the power outlet before cleaning and servicing, or when not in use. Never yank the cord to remove the plug from the outlet.
6. To reduce the risk of electric shock, do not immerse this fixture in water or any other liquids.
7. To reduce the risk of fire or electric shock, do not disassemble this fixture. Contact amaran Customer Support or take the fixture to qualified service personnel when service or repair is required. Incorrect reassembly may cause electric shock when the fixture is in use.
8. The use of any accessory attachment not recommended by the manufacturer may increase the risk of fire, electric shock, or injury to any persons operating the fixture.
9. Please do not place the unit near any flammable object.
10. Only use a dry microfiber cloth to clean the product.
11. Please do not use the light fixture in wet condition on account of electric shock may be caused.
12. Please have the product checked by an authorized service personnel agent if the product has a problem. Any malfunctions caused by unauthorized disassembly are not covered by the warranty. The user may pay for maintenance.
13. We recommend only using the original amaran cable accessories. Please note that any malfunctions caused by using unauthorized accessories are not covered by the warranty. The user may pay for maintenance.
14. This product is certified by ROHS, inspection report. Please operate the product in full compliance with relevant country's standards. Any malfunctions caused by incorrect use are not covered by warranty. The user may pay for maintenance.
15. The instructions and information in this manual are based on thorough, controlled company testing procedures. Further notice will not be given if the design or specifications change.

FCC Compliance Statement

WARNING

Changes or modifications not expressly approved by the party responsible for compliance could void the user's authority to operate the equipment.

NOTICE

This equipment has been tested and found to comply with the limits for a Class B digital device, pursuant to Part 15 of the FCC Rules. These limits are designed to provide reasonable protection against harmful interference in a residential installation. This equipment generates, uses, and can radiate radio frequency energy and, if not installed and used in accordance with the instructions, may cause harmful interference to radio communications. However, there is no guarantee that interference will not occur in a particular installation.

If this equipment does cause harmful interference to radio or television reception, which can be determined by turning the equipment off and on, the user is encouraged to try reorient or relocate the receiving antenna.

- Increase the separation between the equipment and receiver.
- Connect the equipment to an outlet on a different circuit than the receiver is connected to.
- Consult the dealer or an experienced radio/TV technician for help.

RF Warning Statement

This device has been evaluated to meet general RF exposure requirements.

Disclaimer

Before using this product, please read the product manual to ensure correct use under the complete understanding. After reading, please keep the product manual properly for future reference. In case of not operating this product correctly, it may seriously harm yourself or others, or result in product damage and property loss. When using this product, it shall be deemed that you have understood, recognized and accepted all clauses and contents of this document. The user commits to be responsible for their own behaviors and all consequences thereof. amaran shall not be liable for any loss due to the user who does not use this product in accordance with the product manual.

Under the laws and regulations, our company holds the final explanation right of this document and all related documents of this product. No prior notice will be given for any update, revision or termination. Please visit the official amaran website for the latest product information.